



©2016 Lennox Industries Inc.  
Dallas, Texas, USA

## KITS COMMON TO COOLING AND HEAT PUMP UNITS

TPD Technical Publications  
Litho U.S.A.

507591-01  
2/2016

## HAIL GUARD KIT

### INSTALLATION INSTRUCTIONS FOR HAIL GUARD KITS — USED WITH MERIT® SERIES NON-LOUVERED SPLIT SYSTEM OUTDOOR UNITS

#### ⚠ WARNING

Improper installation, adjustment, alteration, service or maintenance can cause property damage, personal injury or loss of life.

Installation and service must be performed by a licensed HVAC professional installer (or equivalent) or service agency.

#### ⚠ CAUTION

As with any mechanical equipment, contact with sharp sheet metal edges can result in personal injury. Take care while handling this equipment and use protective clothing.

#### Shipping And Packing List

Package 1 of 1 contains:

- 9 - Screws (31L4001)
- 2 - Clips (102723) (Kit 14X08 contains no clips)
- 1 - Logo (102474)
- 4 - Louver panels (603153 through 155 series 24" base; 603156 through 158 series 28" base; 603159 through 161 series 32" base)
- 1 - Installation instruction

Check the package for shipping damage. If any damage is found, immediately contact last carrier.

#### Application

This kit can be used to prevent hail damage to the coils of air conditioner and heat pump units. This kit is applicable to all Merit® Series units. Table 1 lists the catalog number and part number for Merit® outdoor equipment louvered panels. Also refer to table 1 to determine catalog/part numbers by panel dimensions.

**NOTE** - All non-louvered Lennox branded residential products are out of production, however product specification bulletins are available on **DaveNet®** under **Products Tab > Product Specifications EHB > Out of Production**. A expandable list will appear with options for air conditioners and heat pumps.

#### Installation

1. Turn off power to the unit.
2. Remove all screws securing wire guard to the unit.
3. Remove the two remaining top panel screws.
4. Remove wire guard.
5. Install the two provided clips on the sides of the control box as shown in figure 1. (Kit 14X08 does not include or require clips.)
6. Install the louvered panels in order, as shown in figure 1, securing the panels with the provided screws. Panel right and panel left are secured to the clips installed in step 5.
7. Turn on power to unit.

Table 1. Kit Applications / Catalog Numbers / Part Numbers

Kit Cat #	Top	Height	Panel Left (1)		Panel Center (2)		Panel Right (1)	
			Cat #	Part #	Cat #	Part #	Cat #	Part #
14X08	24	26	64W93	603155-01	64W90	603154-01	64W87	603153-01
14X09	24	28	64W94	603155-02	64W91	603154-02	64W88	603153-02
14X10	24	32	64W95	603155-03	64W92	603154-03	64W89	603153-03
14X16	28	28	65W07	603158-02	65W02	603157-02	64W97	603156-02
14X19	28	32	65W08	603158-03	65W03	603157-03	64W98	603156-03
14X14	28	36	65W09	603158-04	65W04	603157-04	64W99	603156-04
14X17	28	42	65W10	603158-05	65W05	603157-05	65W00	603156-05
14X20	32	28	65W19	603161-01	65W15	603160-01	65W11	603159-01
14X24	32	32	65W20	603161-02	65W16	603160-02	65W12	603159-02
14X25	32	36	65W21	603161-03	65W17	603160-03	65W13	603159-03
14X18	32	42	65W22	603161-04	65W18	603160-04	65W14	603159-04



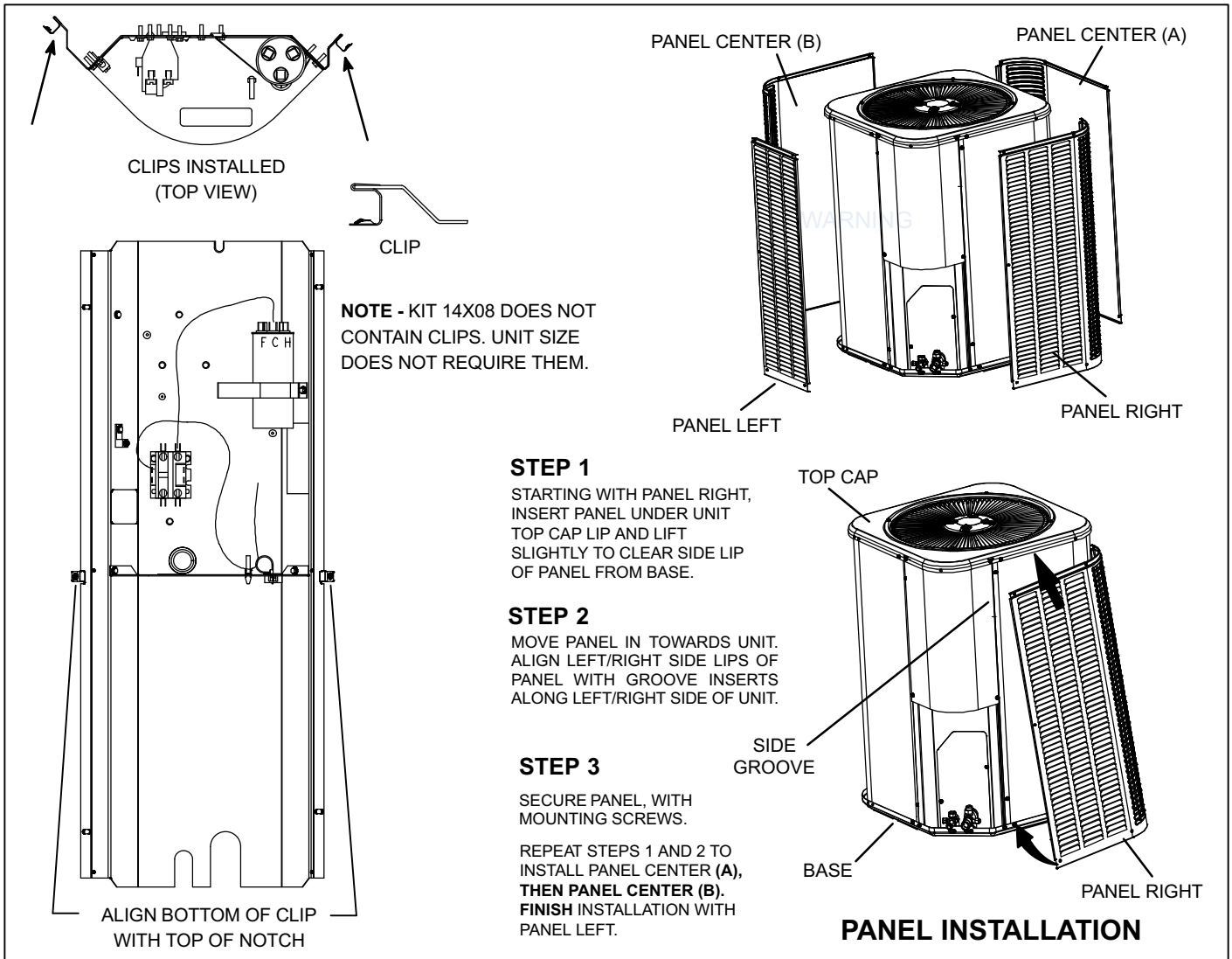

**Figure 1. Installation of Clips and Louvered Panels**