

# GAS UNITS KITS & ACCESSORIES

506583-01  
10/2010

## REPLACEMENT COMBUSTION AIR INDUCER

### INSTALLATION INSTRUCTIONS FOR REPLACEMENT COMBUSTION AIR INDUCER KITS FOR USE ON 80% EFFICIENCY SINGLE-STAGE AND TWO-STAGE GAS FURNACES

#### Shipping and Packing List

##### Package 1 of 1 contains:

- 1 - Two-stage combustion air inducer (CAI) assembly
- 1 - Single-stage combustion air inducer (CAI) assembly
- 1 - Replacement gasket
- 4 - #8-18-1/2" screws
- 1 - 9" length of tubing

#### Application

See table 1 for furnace type and combustion air inducer replacement kit.

TABLE 1

Furnace Type	Kit Number
Two-Stage Upflow/Horizontal (UH)	73W09
Two-Stage Downflow (DF)	70W38
Single-Stage Upflow/Horizontal (UH)	74W55
Single-Stage Downflow (DF)	74W56

#### Installation

### ⚠ WARNING

Disconnect power before servicing unit.  
Shut off main gas supplies to appliance until installation is complete.

### ⚠ WARNING

Improper installation, adjustment, alteration, service or maintenance can cause property damage, personal injury or loss of life. Installation and service must be performed by a licensed professional HVAC installer or equivalent, service agency, or the gas supplier

### ⚠ CAUTION

As with any mechanical equipment, contact with sharp sheet metal edges can result in personal injury. Take care while handling this equipment and wear gloves and protective clothing.

- 1 - Turn off the electrical power and gas supply to the furnace.
- 2 - Remove the flue pipe and top cap.
- 3 - Disconnect the wires from the existing combustion air inducer motor from the integrated control.
- 4 - Disconnect the pressure switch tubing from the pressure tap or barb fitting located on the inducer housing.  
**DF Units Only** -- Remove the screw that secures the internal flue pipe to the inducer. See figure 1. It is not necessary to separate flue chase from internal flue pipe.
- 5 - Remove the four securing screws (figure 2) that secure the combustion air inducer to the flue collector box. Remove the inducer from the furnace.
- 6 - **UH Units Only** -- Remove the flue transition from the existing inducer and install it on the replacement inducer.
- 7 - Replace the gasket between the replacement inducer and orifice plate with the provide gasket.
- 8 - Use the four provided screws to secure the replacement inducer to the flue collector box.
- 9 - Reconnect the provided tubing to the pressure tap or barbed fitting on the inducer housing and the pressure switch. If necessary, cut to length using the existing tubing as a measurement.
- 10 - Reconnect the wires from the replacement inducer to the integrated control.

- 11 - Reinstall the cabinet top cap and access panel.
- 12 - **DF Units Only** -- Scrape away existing Silicone sealant from the internal flue pipe. Apply RTV/high temperature silicone sealant between the internal flue pipe and the combustion air inducer. See figure 3.
- 13 - **UH Units Only** -- Reconnect the vent connector or vent pipe to the flue transition.
- DF Units Only** -- Secure the internal flue pipe to the combustion air inducer using the existing screw. See figures 1 and 3.
- 14 - Restore the electrical power and gas supply to the furnace. Initiate a call for heat and check that the furnace is operating properly.
- 15 - See the unit installation instructions for the start-up procedure.

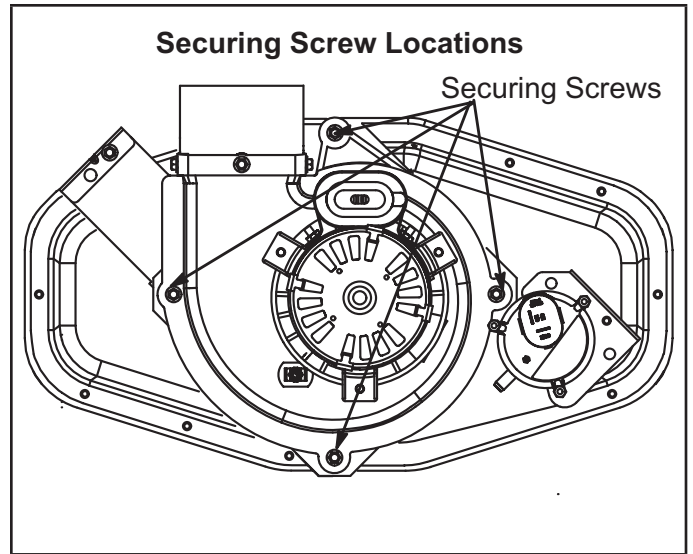

**FIGURE 2**

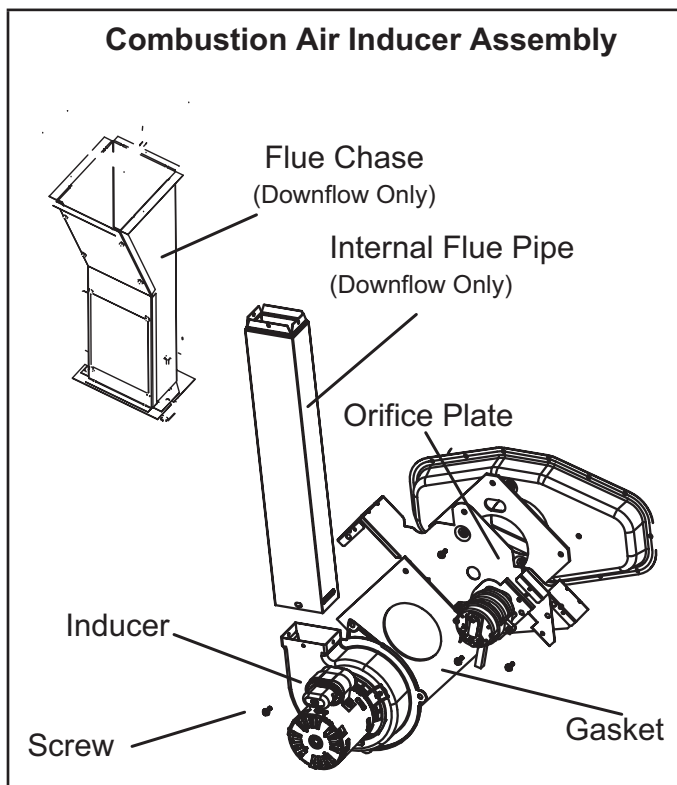

**FIGURE 1**

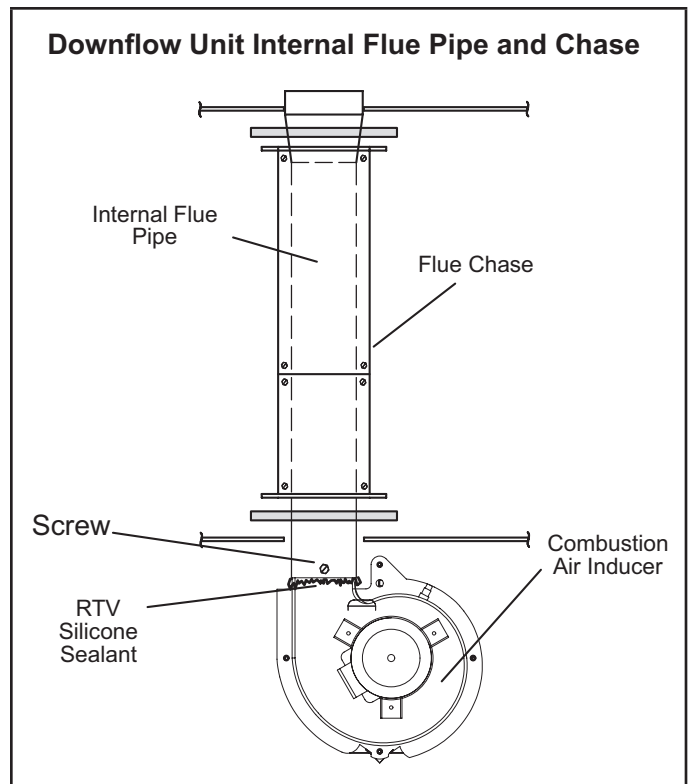

**FIGURE 3**