

INSTALLATION INSTRUCTIONS FOR KIT (84W71), (84W72), (84W73) AND (84W74) USED TO UPGRADE SLP98-1 TO -2 UNITS

Shipping & Packing List

Package 1 of 1 contains:

- 1 - Burner box cover
- 1 - Burner box cover gasket
- 1 - Pressure switch
- 1 - Cold end header box (CEHB)
- 1 - 3/4" elbow
- 1 - 3/4" Drain trap
- 1 - 1" Clamp
- 1 - 1" Cap
- 1 - Left drain hose

Application

See table 1 for SLP98 model input per upgrade kit.

⚠ WARNING

This kit is to be installed by a licensed professional HVAC service technician (or equivalent) or other qualified agency in accordance with the manufacturer's instructions, all codes and requirements of the authority having jurisdiction in the USA, and the requirements of the CSA-B149 installation codes in Canada. If the information in these instructions is not followed exactly, personal injury or loss of life may occur. The qualified agency performing this work assumes responsibility for this conversion.

**TABLE 1
Upgrade Kits**

SLP98 Model Input	Upgrade Kit
070	84W71
090	84W72
110	84W73
135	84W74

Installation

1. -Carefully uncrate unit using care not to damage carton (carton will be reused). Set aside all packing for later use.
 2. -Remove and open bag assembly. Remove 1/2" drain trap, 3/4" clamp, 3/4" cap and 1/2" elbow (if included). Discard the three wire nuts.
 3. -Add the 1" clamp, 1" cap, 3/4" drain trap and 3/4" elbow to the bag assembly. Re-seal bag using tape.
 4. -Remove the furnace access panel.
 5. -Remove the tubing and disconnect the wires from the pressure switch. Label wires and tubing making note of tubing color and negative and positive pressure switch ports.
 6. -Remove and discard the existing pressure switch by carefully pressing the tab which secures the switch assembly to the cold end header box. See figure 2. *Do not install replacement pressure switch at this time.*
 7. -Remove and discard the burner box cover. Set existing screw aside. See figure 1.
 8. -Install replacement burner box cover using existing screw.
 9. -Install replacement burner box cover using existing screw.
- 110 & 135 models**
- Disconnect the 2 wires from the gas valve.
 - Remove the burner box cover and remove gas valve/manifold assembly.
 - Remove sensor wire from sensor. Disconnect 2-pin plug from the ignitor.
 - Disconnect wires from flame roll-out switches.
 - *Upflow Models* - Loosen clamps and remove combustion air intake flexible connector if equipped.
 - Remove four burner box screws at the vestibule panel and remove burner box. Set burner box assembly aside.
 - Remove and replace gasket between the vestibule and the burner box assembly.
 - Reinstall burner box assembly in vestibule area. Secure burner box assembly to vestibule panel using four existing screws. **Make sure burners line up in center of burner ports.**
 - *Upflow Models* - Reconnect combustion air intake flexible connector if removed.
 - Reconnect flame roll-out switch wires.
 - Reinstall gas valve manifold assembly.
 - Install replacement burner box cover with provided white gasket.
 - Reconnect wires to gas valve.
10. -Disconnecting the electrical power wiring harness from the combustion air inducer. Disconnect the ground wire if separate from the plug.
 11. -Loosen clamps securing exhaust fitting to combustion air inducer.



12. -Remove screws (set aside) which secure combustion air inducer to CEHB (figures 3 and 4). Remove combustion air inducer assembly and set aside.
13. -Disconnect drain hoses from CEHB.
Upflow/Horizontal Units - Disconnect left side drain hose from flue coupling and discard hose.
14. -Remove screws securing CEHB to vestibule panel. Set screws aside. Discard CEHB.
15. -Install replacement CEHB (box should be level) using existing screws.
Upflow/Horizontal Units - Install provided left side drain hose. See figure 3.
Downflow Units - Install provided rubber cap on the left side drain port. See figure 4.
16. -Re-connect right side drain hose.
17. -Install replacement pressure switch (from step 6). Reconnect wires to the pressure switch. Take extra care not to bend terminals.
18. -Reconnect pressure switch tubing as shown in figure 5.
19. -Use the existing screws and to reinstall combustion air inducer to the CEHB. Use a torque wrench to tighten screws to 30 in. lbs.
20. -Re-crate the furnace using the original packing material.

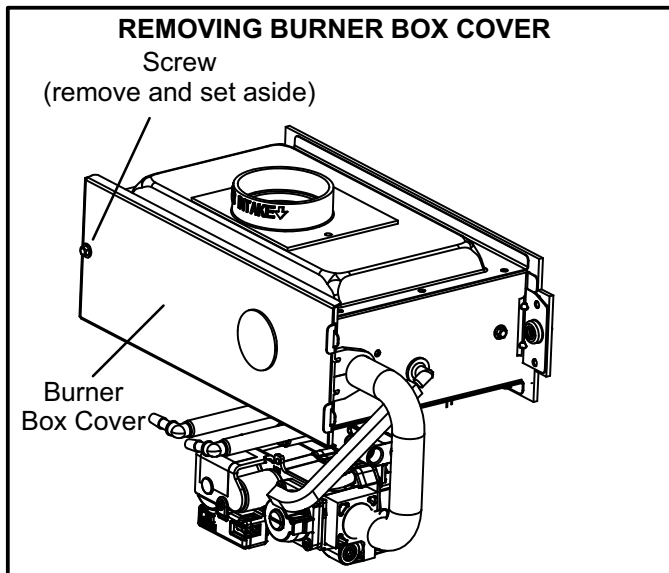

FIGURE 1

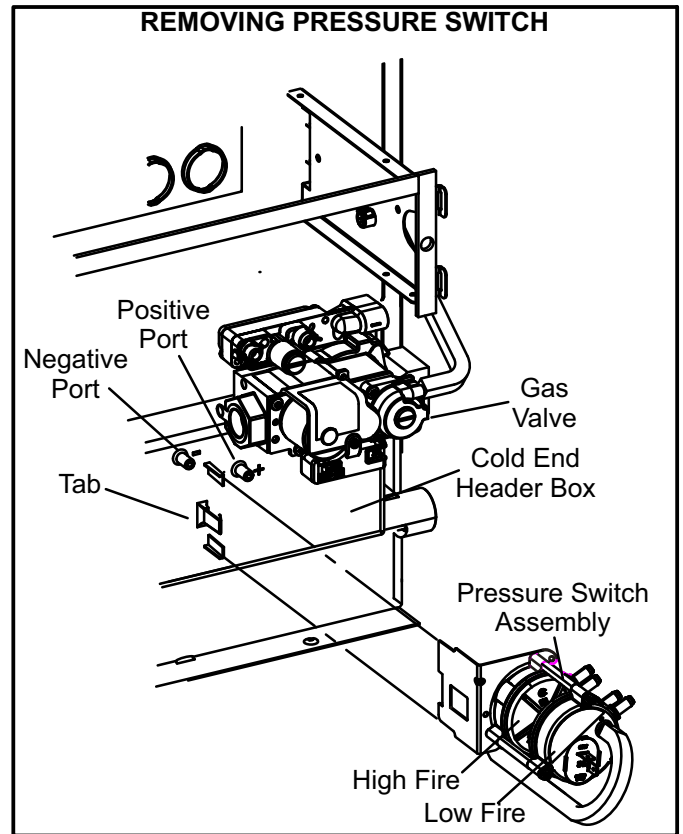

FIGURE 2

Cold End Header Box Upflow/Horizontal Furnaces

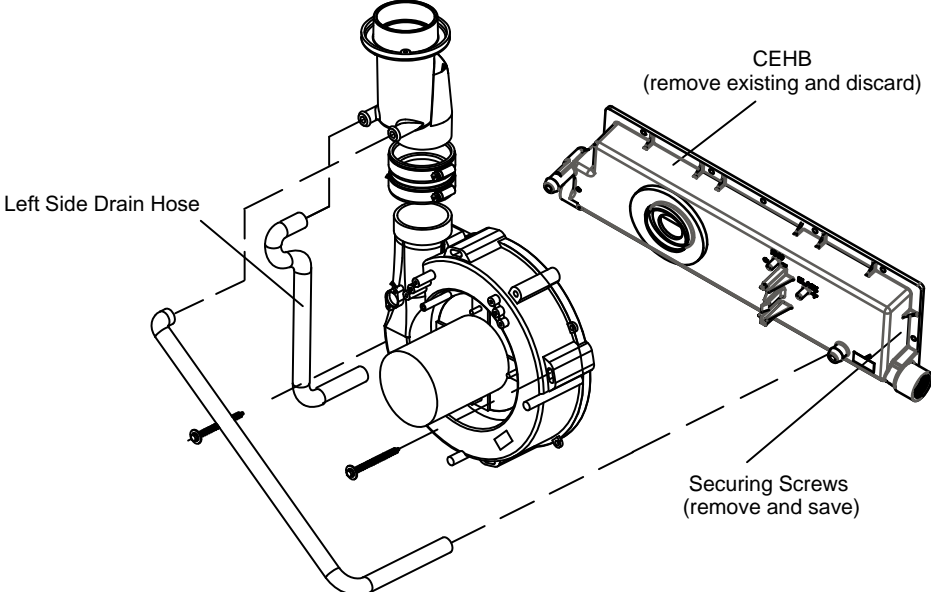

FIGURE 3

Cold End Header Box Downflow Furnaces

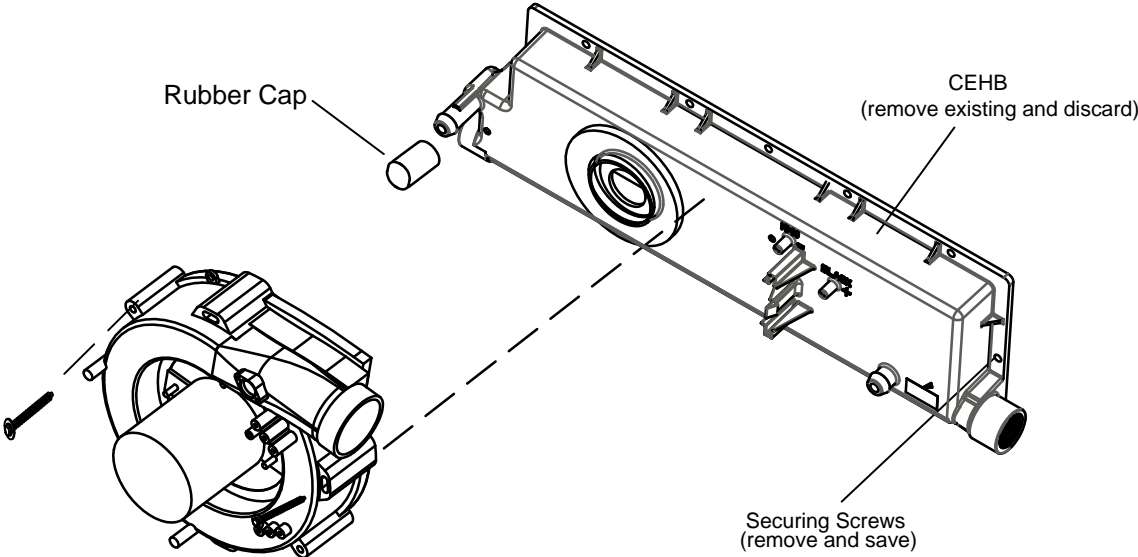
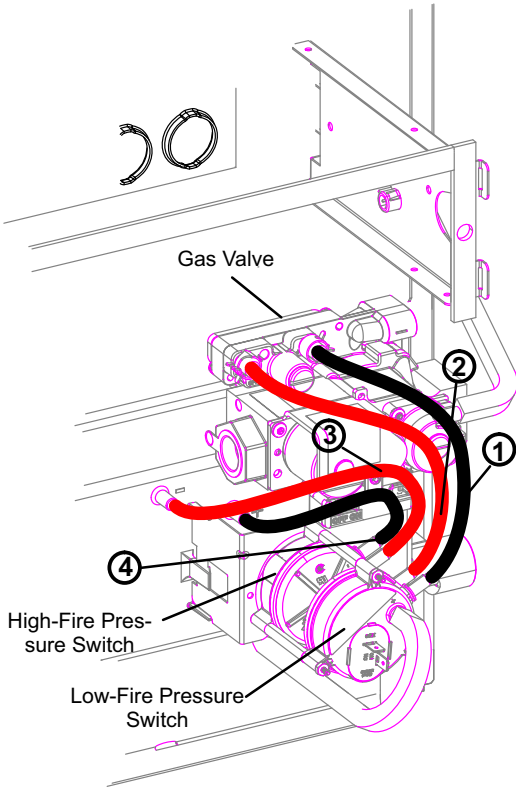

FIGURE 4

**UPFLOW/HORIZONTAL FURNACE
(shown in upflow position)**



- 1 - Black hose from front port on low-fire pressure switch to positive port on the gas valve.
- 2 - Red hose from rear port on low-fire pressure switch to the negative port on the gas valve.
- 3 - Red hose from front port on high-fire pressure switch to negative port on cold end header box.
- 4 - Black hose from rear port on high-fire pressure switch to positive port on cold end header box.

DOWNFLOW FURNACE

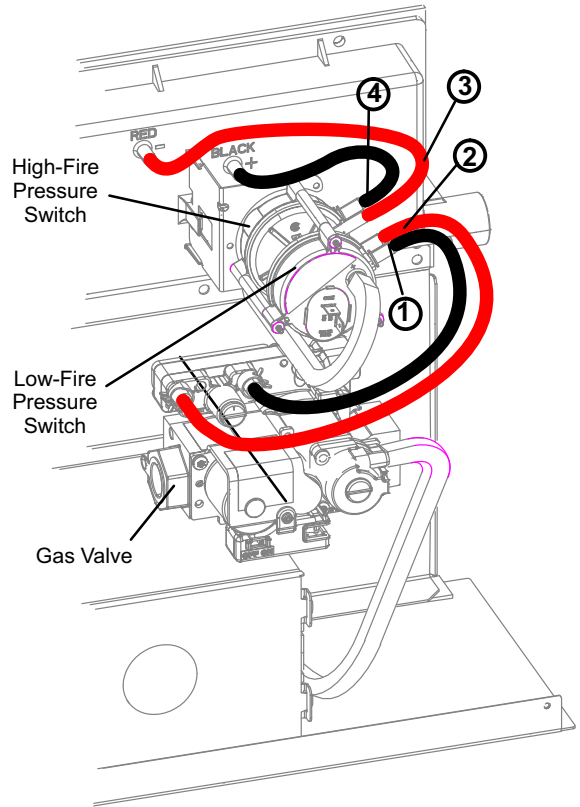

- 1 - Black hose from front port on low-fire pressure switch to positive port on the gas valve.
- 2 - Red hose from rear port on low-fire pressure switch to the negative port on the gas valve.
- 3 - Red hose from front port on high-fire pressure switch to negative port on cold end header box.
- 4 - Black hose from rear port on high-fire pressure switch to positive port on cold end header box.

FIGURE 5