



©2019

GAS UNITS KITS & ACCESSORIES

508015-01
10/2019

INDOOR BLOWER MOTOR REPLACEMENT KIT

INSTALLATION INSTRUCTIONS FOR NIDEC INDOOR BLOWER MOTOR REPLACEMENT KITS 20P42, 20P43, 20P44 USED ON ML296V MODEL UNITS

⚠ WARNING

Improper installation, adjustment, alteration, service or maintenance can cause property damage, personal injury or loss of life. Installation and service must be performed by a licensed professional HVAC installer or equivalent, service agency, or the gas supplier

⚠ CAUTION

As with any mechanical equipment, contact with sharp sheet metal edges can result in personal injury. Take care while handling this equipment and wear gloves and protective clothing.

Shipping and Packing List

Package 1 of 1 contains:

- 1 - Replacement motor

Application

Use the kit specified in the table below to replace the motor ML296V units.

TABLE 1

Model No.	Replacement Kit Catalog No.	Indoor Blower Motor Part No.
ML296UH045XV36B	20P42	620604-01
ML296UH070XV36B		
ML296DF045XV36B		
ML296UH090XV48C	20P43	620604-02
ML296DF070XV48B		
ML296UH110XV60C	20P44	620604-03
ML296DF090XV60C		

Replacement Procedure

- 1 - Disconnect all electrical power to the unit. Wait at least five minutes before beginning service procedures. This will allow internal capacitors to fully discharge, avoiding possible electrical shock.
- 2 - Remove the blower access panel.
- 3 - Remove two screws securing the blower housing to the blower deck and slide blower-motor assembly out of unit. (see figure 1)
- 4 - Unplug all wires from the blower motor
- 5 - Loosen motor shaft set screw and remove all motor mount leg screws. (see figure 1)
- 6 - Loosen motor frame/belly band screw and remove the motor from the blower housing. (see figure 2)
- 7 - Position frame/belly band on to the replacement motor per the dimensions and instructions. (see figure 3 or 4 as applicable)
- 8 - On 3/4hp & 1hp motors, position motor mounting legs in the embossed part of belly band.
- 9 - Tighten motor frame/belly band screw, position motor back on to the blower housing and tighten all motor mount leg screws. Tighten motor shaft set screw as well.
- 10 - Slide blower-motor assembly back into the unit. Secure blower housing back on to the blower deck using screws removed in step 3. (see Figure 1)
- 11 - Plug wires back to the blower motor. Reinstall blower access panel, and power back the unit.

⚠ WARNING

Electric Shock Hazard! Disconnect all power supplies before servicing.
Replace all parts and panels before operating.
Failure to do so can result in death or electrical shock.



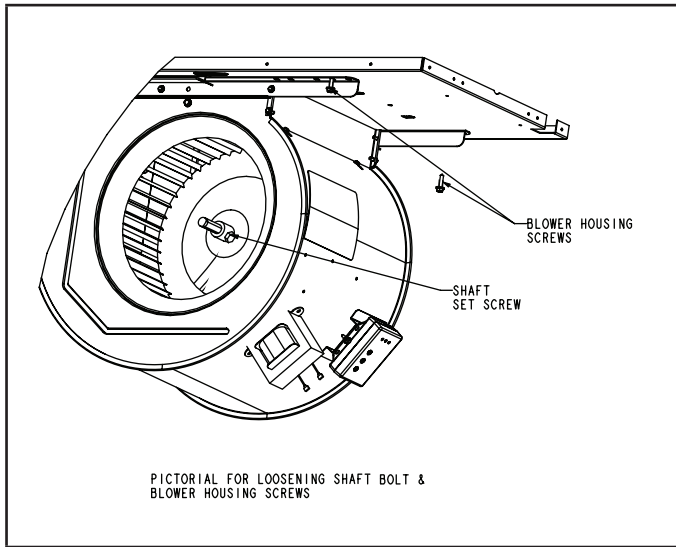

Figure 1

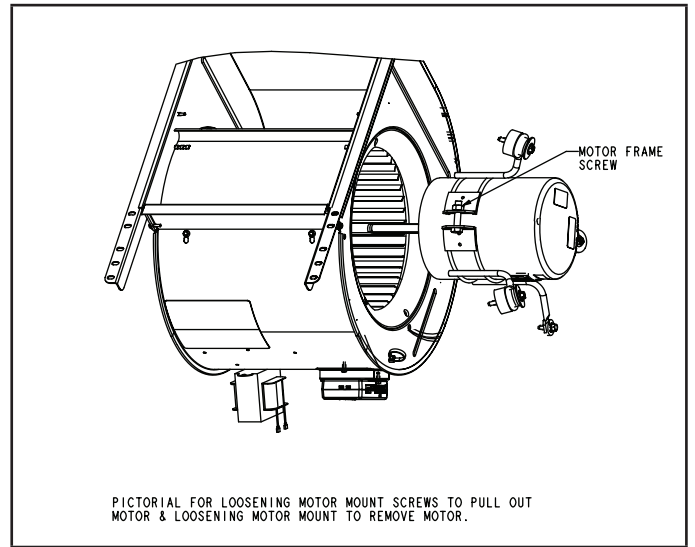

Figure 2

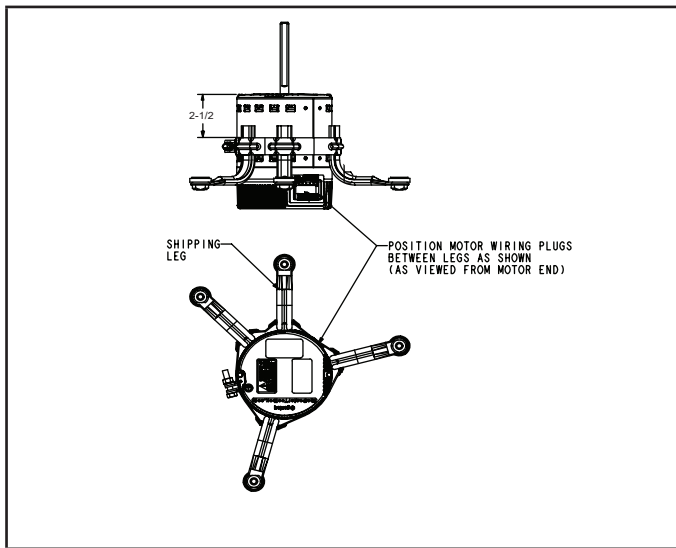

Figure 3

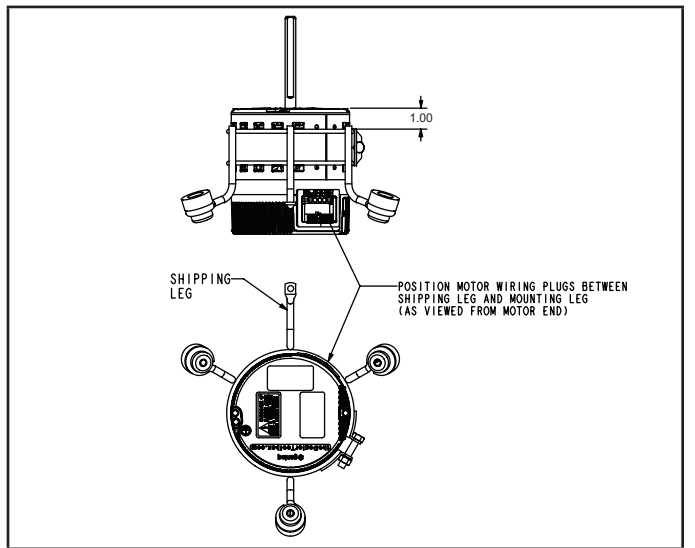

Figure 4