



GAS UNITS KITS & ACCESSORIES

508321-01
07/ 2022

INDOOR BLOWER MOTOR ASSEMBLY REPLACEMENT KIT

INSTALLATION INSTRUCTIONS FOR NIDEC INDOOR BLOWER MOTOR REPLACEMENT ASSEMBLY KIT 24C22 USED ON ML296UH090XV48C-58 MODEL UNITS

⚠ WARNING

Improper installation, adjustment, alteration, service or maintenance can cause property damage, personal injury or loss of life. Installation and service must be performed by a licensed professional HVAC installer or equivalent, service agency, or the gas supplier

⚠ CAUTION

As with any mechanical equipment, contact with sharp sheet metal edges can result in personal injury. Take care while handling this equipment and wear gloves and protective clothing.

Shipping and Packing List

Package 1 of 1 contains:

- 1 - Replacement Nidec motor 3/4 HP (unprogrammed)
- 2 - 16x14 pin wire box (programmed for ML296UH090XV48C-58)
- 3 - 4 pin harness
- 4 - Bracket
- 5 - Screws (4)

Application

Use kit 24C22 to replace the motor used in ML296UH090XV48C-58 units. Furnace must be equipped with 106506-XX ignition control.

Replacement Procedure

- 1 - Disconnect all electrical power to the unit. Wait at least five minutes before beginning service procedures. This will allow internal capacitors to fully discharge, avoiding possible electrical shock.
- 2 - Remove the blower access panel.
- 3 - Remove two screws securing the blower housing to the blower deck and slide blower-motor assembly out of unit. See figure 1.
- 4 - Unplug all wires from the blower motor
- 5 - Loosen motor shaft set screw and remove all motor mount leg screws. See figure 1.
- 6 - Loosen motor belly band screw and remove the motor from the blower housing. See figure 2.

- 7 - Position belly band on to the replacement motor per the dimensions and instructions. See figure 3.
- 8 - Position motor mounting legs in the embossed part of belly band.
- 9 - Tighten motor belly band screw, position motor back on to the blower housing and tighten all motor mount leg screws. Tighten motor shaft set screw as well.
- 10 - Slide blower-motor assembly back into the unit. Secure blower housing back on to the blower deck using screws removed in step 3. See figure 1.
- 11 - Using 2 of the provided screws secure the bracket in the pre-drilled location found on the blower housing. See figure 4.
- 12 - Using the other 2 provided screws secure 16X14 pin wire box on the pre-drilled holes found on their bracket. See figure 5.
- 13 - Connect one end of the 16 pin harness to the ignition control and the other end to the 16X14 pin and connect the provided 4 pin harness from the 16X14 pin box to the motor. See figures 5 and 6.
- 14 - Reinstall blower access panel, and power back the unit.

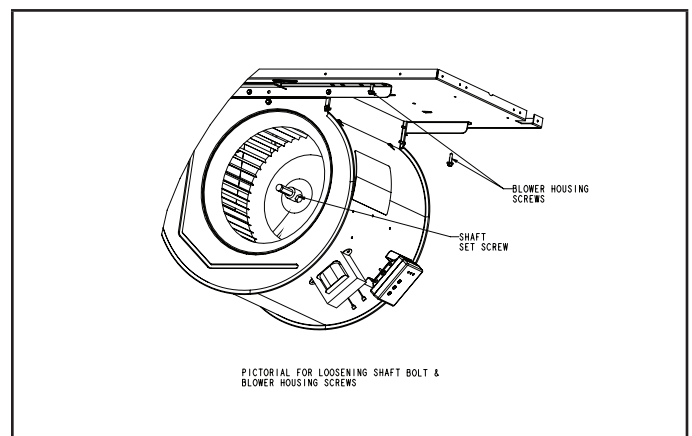

FIGURE 1



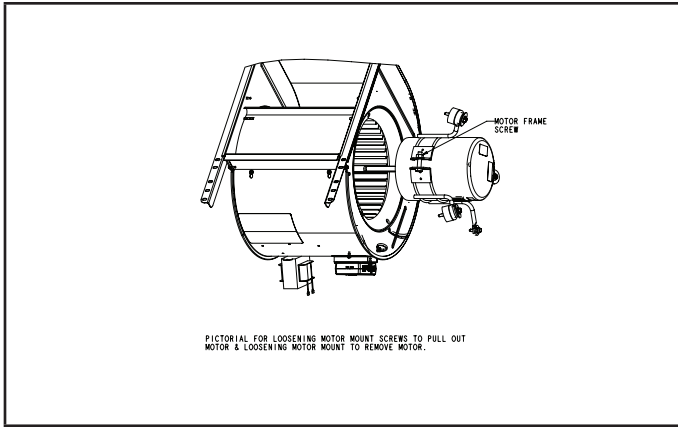

FIGURE 2

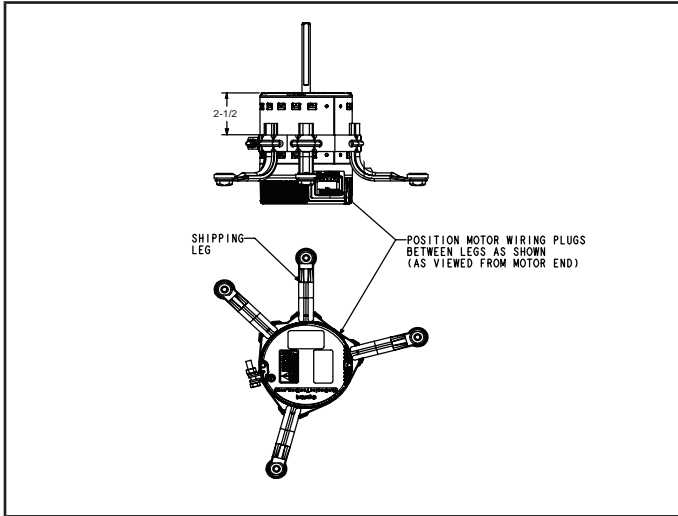

FIGURE 3

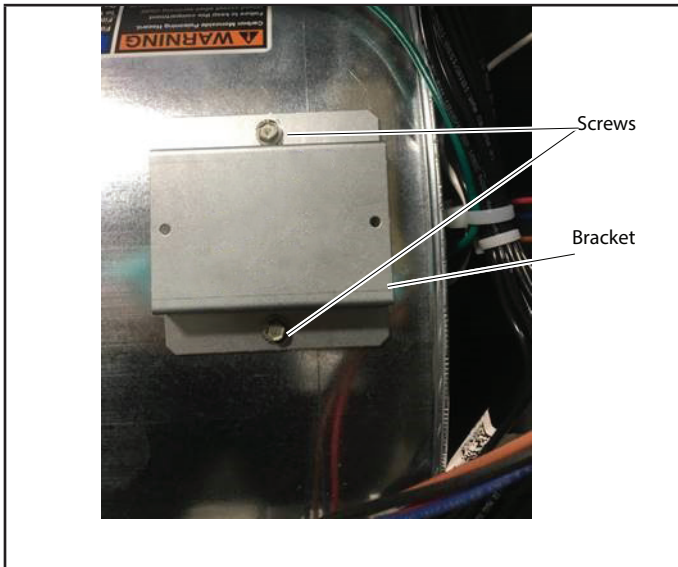

FIGURE 4

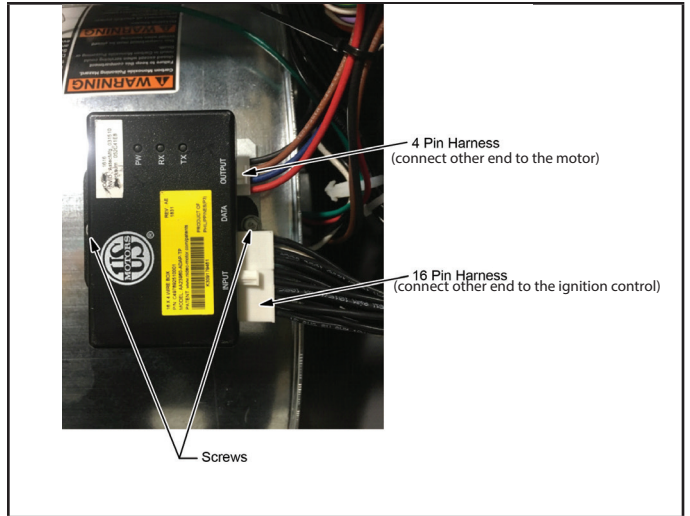

FIGURE 5

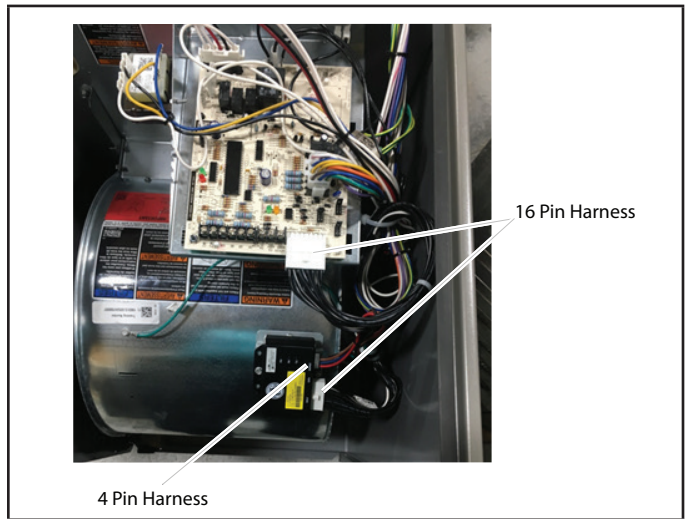

FIGURE 6