



HEAT PUMP OUTDOOR UNITS

XP17N

DAVE LENNOX SIGNATURE® COLLECTION
R-410A - SilentComfort™ Technology

PRODUCT SPECIFICATIONS

Bulletin No. 210618
May 2014
Supersedes December 2013



So simple. So smart. So comfortable.



SEER up to 17.50
2 to 3 Tons

Cooling Capacity - 23,200 to 37,400 Btuh
Heating Capacity - 21,200 to 33,000 Btuh

MODEL NUMBER IDENTIFICATION

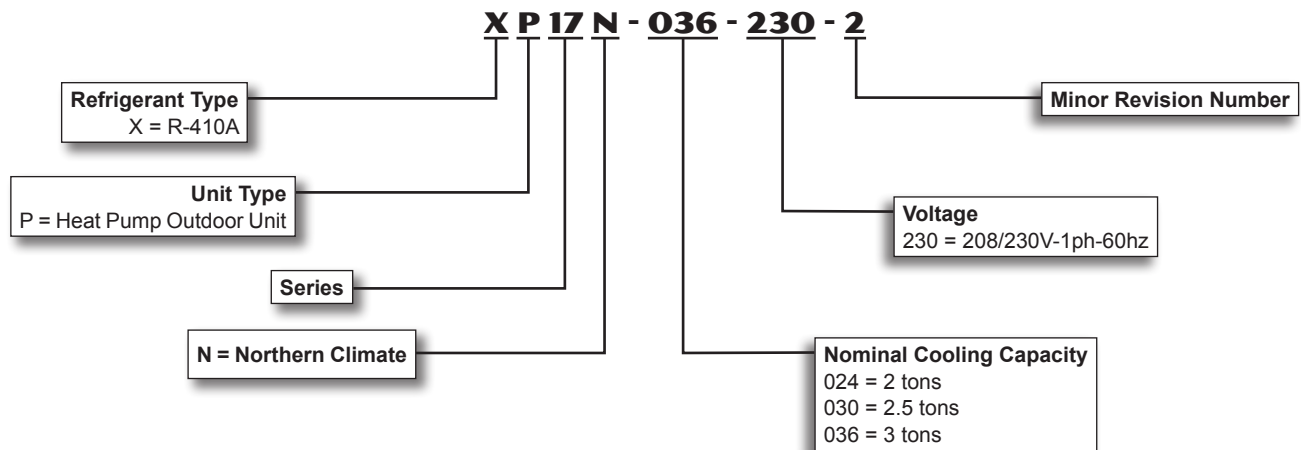

FEATURES

CONTENTS

AHRI System Matches.....	16
Controls	12
Dimensions	14
Electrical Data	12
Features.....	2
Field Wiring.....	13
Installation Clearances	13
Model Number Identification	1
Optional Accessories	12
Sound Data	13
Specifications	12
Sunsource® Home Energy System	8

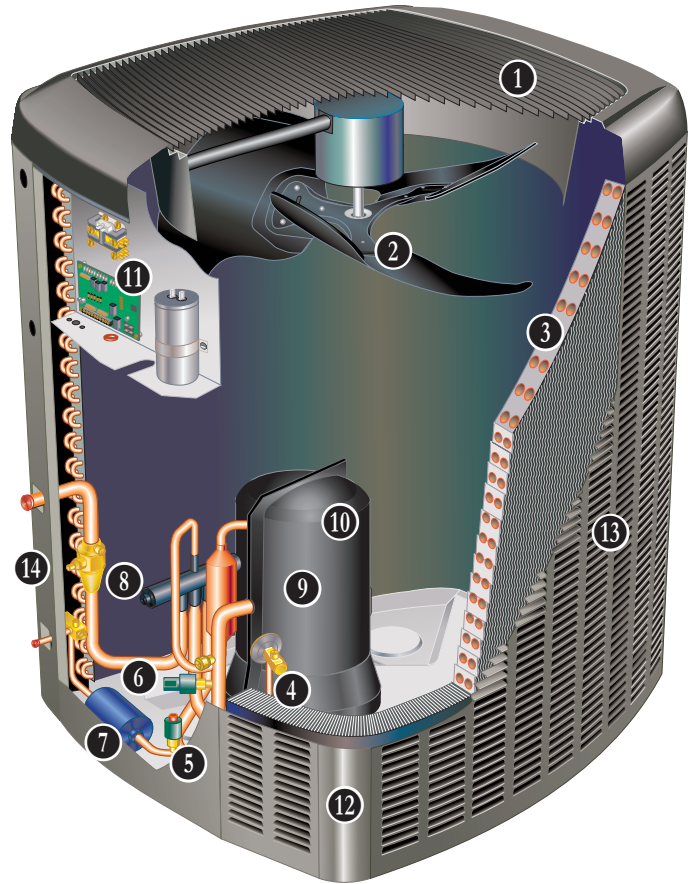

WARRANTY

Compressor - Limited warranty for ten years in residential installations and five years in non-residential installations.

All other covered components - Limited warranty for ten years in residential installations and one year in non-residential installations.

Refer to Lennox Equipment Limited Warranty certificate included with unit for specific details.

APPROVALS

AHRI Certified to AHRI Standard 210/240-2008.

Tested in the Lennox Research Laboratory environmental test room.

Rated according to U.S. Department of Energy (DOE) test procedures.

Heat Pump units and components within bonded for grounding to meet safety standards for servicing required by ETL, NEC and CEC.

Units are ETL certified for the U.S. and Canada.

ISO 9001 Registered Manufacturing Quality System.

ENERGY STAR® certified units are designed to use less energy, help save money on utility bills, and help protect the environment. Many Lennox home comfort systems meet ENERGY STAR requirements when used with matching components.

APPLICATIONS

SEER up to 17.50.

HSPF (Region IV) up to 9.50.

2 through 3 ton.

Single phase power supply.

Sound levels as low as 66 dB.

Vertical air discharge allows concealment behind shrubs at grade level or out of sight on a roof.

Designed for applications with remotely located indoor air handler units or gas furnaces with indoor add-on coils.

When heat pumps are used with gas furnaces, a dual-fuel control or a control system with dual-fuel capabilities (i.e. Harmony III or LZP-4) must be used (order separately).

See Indoor Coils and Air Handlers sections for indoor unit data.

Units shipped completely factory assembled, piped, and wired. Each unit is test operated at the factory insuring proper operation.

Installer must set outdoor unit, connect refrigerant lines, and make electrical connections to complete job.

FEATURES

REFRIGERATION SYSTEM

R-410A Refrigerant

Non-chlorine, ozone friendly, R-410A.

Unit is factory pre-charged with refrigerant. Total system refrigerant charge is dependant on outdoor unit size, indoor unit size and refrigerant line length.

Refer to Installation Instructions for *“Indoor Unit Match-Up and Sub-Cooling Charge Levels”* to determine correct amount of charge required.

See Specification table.



1 Outdoor Coil Fan Guard with SilentComfort™ Technology

Specially-designed, SilentComfort fan guard uses Passive Vortex Suppression to reduce air noise.

Corrosion-resistant PVC (polyvinyl chloride) coated steel wire.

2 Direct drive fan moves large air volumes uniformly through entire outdoor coil for high refrigerant cooling capacity.

Vertical air discharge minimizes operating sounds and eliminates damage to lawn and shrubs.

Fan motor is inherently protected.

All models have a variable-speed outdoor fan motor for quiet operation.

Motor totally enclosed for maximum protection from weather, dust and corrosion.

Fan service access accomplished by removal of fan guard.

3 Copper Tube/Enhanced Fin Coil

Lennox designed and fabricated coil.

Ripple-edged aluminum fins.

Copper tube construction.

Lanced fins provide maximum exposure of fin surface to air stream resulting in excellent heat transfer.

Fin collars grip tubing for maximum contact area.

Flared shoulder tubing connections/silver soldering construction.

Coil is factory tested under high pressure to insure leakproof construction.

Entire coil is accessible for cleaning.

4 Expansion Valve - Outdoor Unit

Designed and sized specifically for use in heat pump system.

Sensing bulb is located on the suction line between the coil and the reversing valve thus sensing evaporator out temperature in the heat cycle.

Factory installed and piped.

5 High Pressure Switch

Shuts off unit if abnormal operating conditions cause the discharge pressure to rise above setting.

Protects compressor from excessive condensing pressure.

Manual reset.

6 Low Pressure Switch

Shuts off unit if suction pressure falls below setting.

Provides loss of charge and freeze-up protection.

Automatic reset.

7 Hi-Capacity Liquid Line Drier

Factory installed in the liquid line, the drier traps moisture or dirt that could contaminate the refrigerant system.

100% molecular-sieve bead type drier.

8 Reversing Valve

4-way interchange reversing valve effects a rapid change in direction of refrigerant flow resulting in quick changeover from cooling to heating and vice versa.

Valve operates on pressure differential between outdoor unit and indoor unit of the system. Factory installed.

Optional Accessories

Check/Expansion Valve Kits

Must be ordered extra and field installed on certain evaporator units. See TXV Usage table.

Chatleff style fitting.

Freezestat

Installs on or near the discharge line of the evaporator or on the suction line.

Senses suction line temperature and cycles the compressor off when suction line temperature falls below it's setpoint.

Opens at 29°F and closes at 58°F.

Mild Weather Kit

For heat pump heating operation in mild weather climates. A pressure switch automatically cycles the outdoor fan motor when the head pressure rises above normal operating conditions.

Refrigerant Line Kits

Refrigerant lines (suction & liquid) are shipped refrigeration clean. Lines are cleaned, dried, pressurized, and sealed at factory.

Suction line fully insulated.

L15 lines are stubbed at both ends.

See Specifications table for selection.

FEATURES

COMPRESSOR

9 Scroll Compressor

Compressor features high efficiency with uniform suction flow, constant discharge flow, high volumetric efficiency and quiet operation.

Compressor consists of two involute spiral scrolls matched together to generate a series of crescent shaped gas pockets between them. During compression, one scroll remains stationary while the other scroll orbits around it. Gas is drawn into the outer pocket, the pocket is sealed as the scroll rotates. As the spiral movement continues, gas pockets are pushed to the center of the scrolls. Volume between the pockets is simultaneously reduced.

When the pocket reaches the center, gas is now at high pressure and is forced out of a port located in the center of the fixed scrolls.

During compression, several pockets are compressed simultaneously resulting in a smooth continuous compression cycle.

Continuous flank contact, maintained by centrifugal force, minimizes gas leakage and maximizes efficiency.

Scroll compressor is tolerant to the effects of slugging and contaminants. If this occurs, scrolls separate, allowing liquid or contaminants to be worked toward the center and discharged.

Low gas pulses during compression reduces operational sound levels.

Compressor motor is internally protected from excessive current and temperature.

Compressor is installed in the unit on resilient rubber mounts for vibration free operation.

Factory installed crankcase heater.

Crankcase Heater

Crankcase heater prevents migration of liquid refrigerant into compressor and ensures proper compressor lubrication.

10 Compressor Sound Dampening System

A polyethylene compressor cover containing a 2 inch thick batt of fiberglass insulation for better sound dampening.

All open edges are sealed with a one-inch wide hook and loop fastening tape.

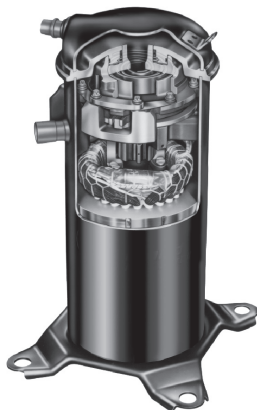

CONTROLS

11 iComfort™ Control

Advanced icomfort™ control communicates information about various operating parameters in the heat pump outdoor unit to the optional *iComfort Wi-Fi® Thermostat* to constantly maintain the highest level of comfort, performance and efficiency available.



Connections for connecting a conventional heat pump thermostat are also provided.

Auto Configuration - On start-up the control automatically sends a description of the unit to the optional *iComfort Wi-Fi® Thermostat* to automatically configure the number of stages and features available.

Seven-Segment Display

Seven-segment display shows information about outdoor unit type and capacity and also displays alerts for common fault conditions (electrical and mechanical).

Control also features:

- Compressor anti-short cycle delay (5 minutes).
- Compressor defrost shift delay - Adjustable 0 (factory) or 30 seconds.
- Demand defrost using outdoor ambient air temperature, coil temperature and compressor run-time inputs. 14 minute maximum defrost time.
- Selectable defrost termination temperature - 50, 70, 90 or 100°F. Default setting is 50°F.
- High and low pressure switch monitoring with provisions for lockout.
- Five-Strike lockout protection protects compressor.
- Outdoor air temperature and sensor monitoring.
- Fan cycling operates outdoor fan for 5 minutes when outdoor ambient air temperature is between 15°F and 35°F and the compressor has been off for 25 to 30 minutes. Reduces the potential for ice buildup on the fan orifice ring. User selectable 5 minutes on or off (default setting).
- Lennox Humiditrol® Whole Home Dehumidification System (EDA) compatible.
- EEPROM storage of all local configurations.

FEATURES

CONTROLS (continued)

Optional Accessories

Compressor Hard Start Kit

Single-phase units are equipped with a PSC compressor motor.

This type of motor normally does not need a potential relay and start capacitor.

In conditions such as low voltage, kit may be required to increase the compressor starting torque.

Indoor Blower Off Delay Relay

Delays the indoor blower-off time during the cooling cycle.

Indoor Blower Speed Relay Kit

Relay kit provides optimum humidity control conditions by automatically reducing indoor blower speed during continuous fan operation.

Low Ambient Kit

Outdoor units will operate in the cooling mode satisfactorily down to 45°F outdoor air temperature without any additional controls.

Kit can be added in the field enabling unit to operate properly down to 30°F.

A Freezestat should be installed on compressors equipped with a low ambient kit.

A Compressor Low Ambient Cut-Off should be added to terminate compressor operation below recommended operation conditions.

Monitor Kit - Service Light

Contains ambient compensating thermistor and service light thermostat.

For use with thermostats requiring input for indicator lights.

Outdoor Thermostat Kit

An outdoor thermostat can be used to lock out some of the electric heating elements on indoor units where two-stage control is applicable.

Outdoor thermostat maintains the heating load on the low power input as long as possible before allowing the full power load to come on the line.

Thermostat kit and mounting box must be ordered separately.

FEATURES

CONTROLS (continued)

Optional Accessories

iComfort Wi-Fi® Thermostat (part of the iComfort™ Residential Communicating Control System)

The *iComfort Wi-Fi® Thermostat* recognizes and connects to

all *iComfort™*-enabled products to automatically configure and control the heating/cooling system (based on user-specified settings) for the highest level of comfort, performance and efficiency. Also recognizes model and serial number information for *iComfort™*-enabled products to simplify system installation.

Wi-Fi remote temperature monitoring and adjustment through a home wireless network for desktop PCs, laptops and apps for smartphones or tablets. Service alerts and reminders sent via text message or e-mail.

Dealer Dashboard features online real-time monitoring of installed *iComfort™* systems.

A simple easy-to-use touchscreen allows complete system configuration. Scheduled maintenance alerts, system warnings and troubleshooting are also displayed on thermostat screen.

Easy to read 7-inch color screen (measured diagonally). Conventional outdoor units (not *iComfort™*-enabled) can easily be added and controlled by the *iComfort Wi-Fi® Thermostat*.

Installer setup screens allow quick and simple system configuration without a manual, Installer can also run tests on complete system or individual components for easy maintenance and troubleshooting.

Serial communications bus (RSBus), with less wiring than a conventional heating/cooling system, allows system communication. Uses 4-wire, 18-gauge standard thermostat wiring.

See the *iComfort Wi-Fi® Thermostat* Product Specifications bulletin in the Controls section for more information.



ComfortSense® 7000 Touchscreen Thermostat

Electronic 7-day, universal, multi-stage, programmable, touchscreen thermostat.

4 Heat/2 Cool.

Auto-changeover.

Controls humidity during cooling mode.

Offers enhanced capabilities including humidification / dehumidification / dewpoint measurement and control, *Humiditrol®* control, and equipment maintenance reminders.

Easy-to-use, menu driven thermostat with a back-lit, LCD touchscreen.

Remote outdoor temperature sensor (optional) allows the thermostat to display outdoor temperature. Required in dual-fuel and *Humiditrol®* applications.

See the *ComfortSense® 7000* Product Specifications bulletin in the Controls section for more information.

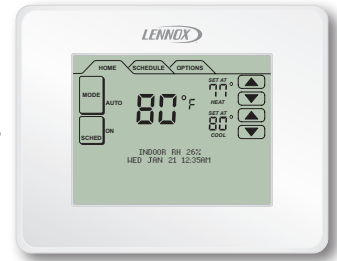

Outdoor Temperature Sensor

Used with the *iComfort Wi-Fi® Thermostat* and *ComfortSense® 7000* thermostat.

When installed outdoors, sensor allows thermostat to display outdoor temperature. Sensor is auto-detected when connected to thermostat.

NOTE - Sensor is required for dual fuel and *Humiditrol®* applications.

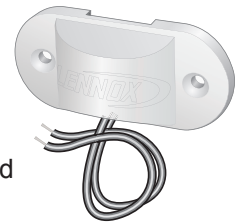

Thermostat

Thermostat (*iComfort Wi-Fi® Thermostat* or programmable/non-programmable) is not furnished with unit.

See Thermostat bulletins in Controls Section and Lennox Price Book for selection.

FEATURES

12 CABINET

Heavy-gauge steel construction

Pre-painted cabinet finish.

Control box is conveniently located with all controls factory wired.

Large removable panel provides service access.

Drainage holes are provided in base section for moisture removal.

High density polyethylene unit support feet raise the unit off of the mounting surface, away from damaging moisture.

PermaGuard™ Unit Base

Durable zinc-coated base section resists rust and corrosion.

13 SmartHinge™ Louvered Coil Protection

Steel louvered panels provides complete coil protection.

Panels are hinged to allow easy cleaning and servicing of coils.

Panels may be completely removed.

Interlocking tabs and slots assure tight fit on cabinet.



Refrigerant Line Connections, Electrical Inlets and Service Valves

14 Vapor and liquid lines are located on corner of unit cabinet and are made with sweat connections. See dimension drawing.

Fully serviceable brass service valves prevent corrosion and provide access to refrigerant system. Vapor valve can be fully shut off, while liquid valve may be front seated to manage refrigerant charge while servicing system.

Vapor and liquid line service valves and gauge ports are located inside the cabinet.

Refrigerant line connections and field wiring inlets are located in one central area of the cabinet. See dimension drawing.

Optional Accessories

Snow Guards

For use in locations where the possibility of heavy snow or freezing rain accumulation may occur.

Heavy gauge powder coated steel guard deflects snow and ice away from the outdoor fan and prevents build-up on the fan guard.

SUNSOURCE® HOME ENERGY SYSTEM - COMPONENTS

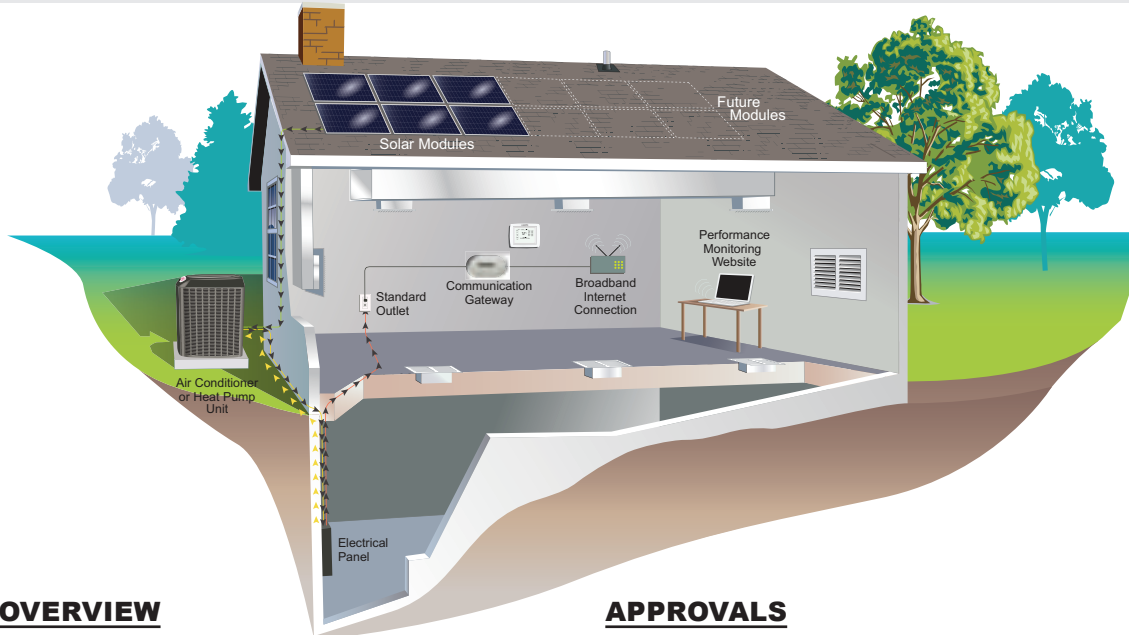

SYSTEM OVERVIEW

All Dave Lennox Signature® Collection air conditioners and heat pumps are equipped at the factory for upgrading to the SunSource® Home Energy System. Units can be upgraded at the time of installation or in the future.

Solar energy is first used to meet cooling/heating demands. When the cooling/heating system is not operating, the system powers lighting, appliances and other electronic devices in the home. And in some locations, any surplus power is sent back to the utility company for a possible credit (check with your local utility company for availability).

The SunSource system consists of the following components:

- Lennox Solar Sub-Panel field installed in a Dave Lennox *Signature*® Collection air conditioner or heat pump unit.
- SolarWorld Pre-Engineered Kits consisting of:
 - SolarWorld Solar Modules (1 to 17 may be used to vary the amount of electricity generated).
 - Enphase Microinverter that converts Direct Current to Alternating Current.
 - Enphase Envoy Communications Gateway for solar power performance monitoring.
 - Roof Mounting Components

Wiring from the roof mounted solar modules is routed to the outdoor unit. From there power travels to the home electrical service panel using the existing outdoor unit power wiring.

NOTE - Refer to separate Product Specifications Bulletin for the SunSource® Home Energy System for more detailed information. See section Solar - Kits/ Accessories.

Also refer to **SunSource® Home Energy System Applications and Design Guidelines** Manual (Corp. 1312-L2) for complete information on designing, sizing and installing a complete system.

APPROVALS

The SunSource® Home Energy System meets the requirements for federal tax credit eligibility listed under the U.S. Emergency Economic Stabilization Act of 2008, covering 30% of the cost of the solar modules, including installation.

LENNOX® SOLAR SUB-PANEL

The Lennox® Solar Sub-Panel replaces the factory piping panel on the outdoor unit and provides circuit breaker protection and power entry for both HVAC (line) and solar power wiring.

Sub-Panel is equipped with separate circuit breakers for both HVAC (line) voltage and solar power.

Equipped with pigtail connections for easy field wiring.

Sub-Panel is an ETL listed accessory.

Split design (upper/lower panel) allows installation on different size outdoor units. Sub-Panel is furnished with three separate lower panels. See Outdoor Unit Usage table for correct lower panel size.

NOTE - Sub-Panel is not backwards compatible with older non Solar-Ready Dave Lennox Signature® Collection outdoor units.

Disconnects for HVAC (line) and solar power wiring are not furnished and must be field provided.

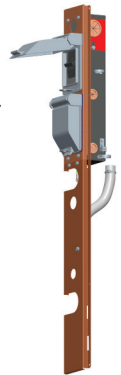

SUNSOURCE® HOME ENERGY SYSTEM - COMPONENTS

SOLAR MODULE

Captures solar energy to convert into AC power through the Enphase Microinverter.

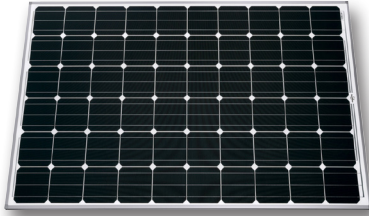

Laminated solar module structure consists of the solar glass, two ethylene vinyl acetate (EVA) sheets, the solar cell matrix and a back sheet.

Thick low-iron safety glass withstands extreme weather conditions and heavy snow loads.

Solar modules are ETL/Intertek listed for the US and Canada to UL Standard 1703 and meet National and Canadian Electrical Code requirements.

Solar Module Frame

Available in black or clear anodized silver frame with cast aluminum corner keys.

Low profile with extended flange.

Compatible with “top-down” and “bottom-up” mounting methods.

Eight grounding locations (Four corners of the frame and four locations along the length of the module in the extended flange).

Extended cable lengths for easier installation.

SYSTEM MONITORING

Enphase Envoy Communications Gateway (Communications Booster Furnished)

The Enphase Envoy Communications Gateway monitors microinverter (on solar modules) performance and can be connected to a broadband internet connection to send data to the Enphase



Enlighten™ web site for online monitoring by the homeowner. The Enphase Envoy Communications Gateway is not required, but must be used if system performance monitoring is desired.

System monitoring is also available locally with the Enphase Envoy Communications Gateway and a personal computer if no internet connection is available.

Various Event Messages are also available when monitoring the system via a personal computer locally.

Contents - (1) Enphase Envoy Communications Gateway, (1) 6 ft. power cord, (1) 10 ft. Ethernet cable, communications booster.

CSA (US/C) listed.

Communications Booster

Ethernet bridge signal booster for the Enphase Envoy Communications Gateway. Booster is only needed if the communications gateway is installed and signal is not strong enough in the installed location. Allows the unit to be plugged into an outlet closer to the distribution panel, yet still plug into the broadband router.

Enphase Enlighten™ Performance Monitoring Website

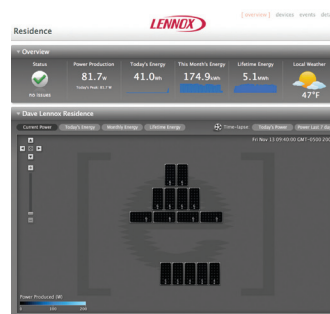

Powered by the Enphase Envoy Communications Gateway, the Enphase Enlighten™ Performance Monitoring website allows the homeowner to keep track of home energy usage and see environmental benefits in real time. Also aids in troubleshooting any solar-

related issues.

See demos, view reference installations and other additional information at:

<http://enlighten.enphaseenergy.com>

ROOF MOUNTING COMPONENTS

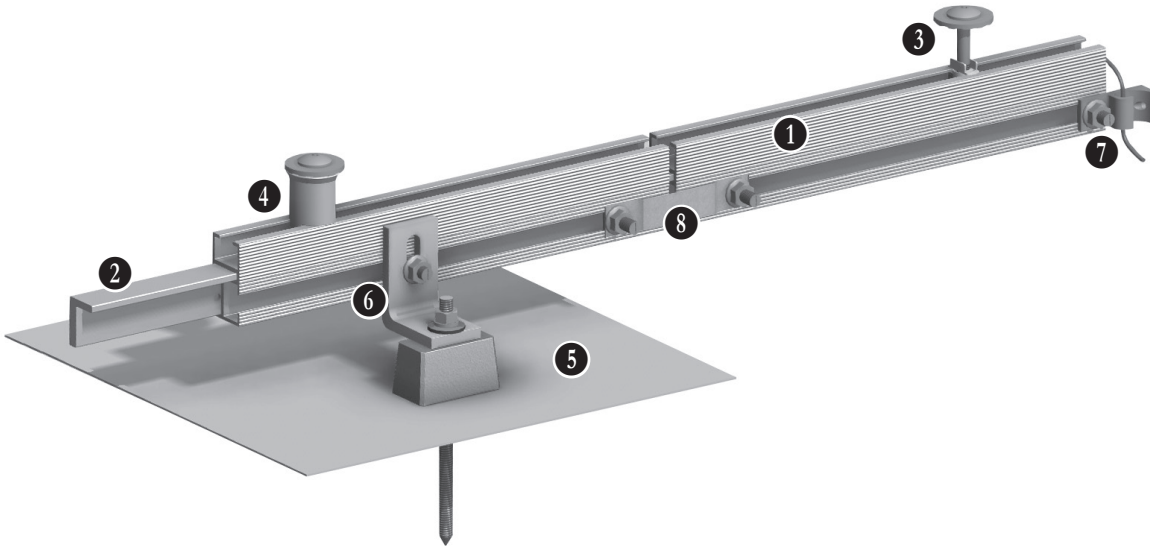

- 1 **Rails** - Provides a mounting surface for Solar Modules in portrait orientation using associated hardware. Serrations on sides of rails provide a secure and stable mating surface for hardware (L-Brackets, Rail Splice Ground Jumper, Ground Lug). Available in 122 in. (3099 mm) and 162 in. (4115 mm) lengths.
- 2 **Rail Splice Bar Connector** - For connecting two lengths of rail together. No fasteners required. Pin on center of splice leaves a gap between rails to allow for thermal expansion.
- 3 **Top Clamp Assembly (Silver or Black)** - M8 T40 bolt with channel nut, bolt positioning retainer and serrated module clamping washer. Inserts into rail slot to secure modules and set spacing in-between each one.
- 4 **End Clamp Aluminum Spacer (Silver or Black)** - Used with Top Clamp Assembly for securing the end of module mounting row.
- 5 **Composition Roof Mount/Flashing (Mil Aluminum or Bronze)** - Provides roof mounting surface for mounting system. Size - 12 x 12 in. (305 x 305 mm). Base block, hanger bolt and hardware furnished. Adds 1-1/4 in. (32 mm) height below the L-Bracket.
- 6 **L-Bracket** - Clear anodized aluminum with serrated mating surface. Fastens rail to Roof Mount/Flashing. Has two 1 in. (25 mm) slots that provide adjustment from 2-1/2 to 3-1/2 in. (64 to 89 mm).
- 7 **Wire Clip (not shown)** - Provides wire management for solar array wiring. Fastens to edge of rail. For 10 AWG.
- 8 **Ground Lug (not shown)** - Tin plated, WEEB 8.0, lay-in type. Mounts to corner of solar module.
- 7 **Rail-Equipment Ground WEEB 8.0 Lug** - T-bolt slides into rail for secure connection.
- 8 **Rail Splice Ground Jumper** - WEEB 8.0, pre-assembled with T-bolts. Electrically bonds rails together. Required at each rail splice.

Interconnection cable to wiring/conduit to the outdoor unit. ETL-listed weather-tight enclosure.

Passthru Kit (not shown) - Used with Rooftop Junction Box. One-branch AC passthru kits. Contains all necessary wiring hardware.

ENPHASE ENGAGE CABLE COMPONENTS

Enphase Engage Cable - The Engage Cable (shown with connector) is a 12 AWG cable with pre-installed connectors (portrait aligned) that plug into the Microinverter. Four wire cable (240V single-phase).



Enphase Engage Cable Terminator - Each Engage Cable is terminated at a junction or combiner box. The opposite end of the cable must be terminated with an Engage Cable Terminator cap.



Enphase Engage Disconnect Tool -



Specialized tool that disconnects the Engage Cable from a Microinverter or watertight sealing cap.

Enphase Engage Water-tight Sealing Cap - Use when open connections on the Engage Cable are not mated to a Microinverter.



ENPHASE MICROINVERTER MOUNTING

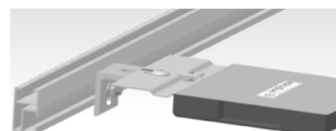

L-Bracket and associated hardware to mount microinverter to rail.

SUNSOURCE® - PRE-ENGINEERED KITS

ORDERING

SunSource® Pre-Engineered Kits are available for composition shingle roofs, standing seam roofs, trapezoid metal roofs, flat tile roofs and S tile roofs. See the Sunsource Home Energy System Product Specifications bulletin for complete Pre-Engineered Kits ordering instructions and the Ordering Process Flowchart/Worksheet.

The Installation Package contains the appropriate number of required Rails, Splices, Brackets, Clamps, Clips and assorted hardware (nuts/bolts/washers) for the installation.

NOTE

The Lennox® Solar Sub-Panel for the outdoor unit must be ordered separately. See below for ordering information.

Lennox® Solar Sub-Panel

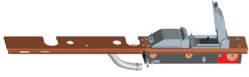

Order one per outdoor unit. Replaces the outdoor unit piping panel and provides the connection between the solar modules and outdoor unit.

62E02

LENNOX® SOLAR SUBPANEL - OUTDOOR UNIT USAGE

Outdoor Unit Model No.	Lower Subpanel Height - in. (mm)
	17 (432)
XP17N-024-030-036	X

SPECIFICATIONS

General Data		Model No.	XP17N-024	XP17N-030	XP17N-036
Nominal Tonnage			2	2.5	3
Connections (sweat)	Liquid line (o.d.) - in.		3/8	3/8	3/8
	Vapor (Suction) line (o.d.) - in.		3/4	3/4	7/8
Refrigerant	¹ R-410A charge furnished		9 lbs. 7 oz.	9 lbs. 11 oz.	10 lbs. 2 oz.
Outdoor Coil	Net face area	Outer coil	20.73	20.73	20.73
		Inner coil	20.08	20.08	20.08
	- sq. ft.				
	Tube diameter - in.		5/16	5/16	5/16
	No. of rows		2	2	2
Fins per inch		22	22	22	
Outdoor Fan	Diameter - in.		26.0	26.0	26.0
	No. of blades		3	3	3
	Motor hp		1/3	1/3	1/3
	Cfm		2530	2530	3320
	Rpm		700	700	700
	Watts		65	65	120
Shipping Data - lbs. 1 pkg.			287	287	288

ELECTRICAL DATA

Line voltage data - 60hz - 1 ph		208/230V	208/230V	208/230V
² Maximum overcurrent protection (amps)		30	30	40
³ Minimum circuit ampacity		20.0	20.4	23.7
Compressor	Rated load amps	13.5	14.1	16.7
	Locked rotor amps	58.3	73.0	79.0
	Power factor	0.99	0.99	0.97
Outdoor Fan Motor	Full load amps	2.8	2.8	2.8

CONTROLS

iComfort Wi-Fi [®] Thermostat	10F81	•	•	•
⁴ Remote Outdoor Temperature Sensor (for dual fuel and Humiditrol [®])	X2658	•	•	•
⁵ Discharge Air Temperature Sensor	88K38	•	•	•
ComfortSense [®] 7000 Thermostat	Y0349	•	•	•
Outdoor Temperature Sensor - for ComfortSense 7000 Thermostat	X2658	•	•	•

OPTIONAL ACCESSORIES - ORDER SEPARATELY

Compressor Hard Start Kit	88M91	•	•	•
Freezestat	3/8 in. tubing	93G35	•	•
	5/8 in. tubing	50A93	•	•
⁷ Low Ambient Kit	68M04	•	•	•
Indoor Blower Off Delay Relay	58M81	•	•	•
Mild Weather Kit	11B97	•	•	•
Monitor Kit - Service Light	76F53	•	•	•
Outdoor Thermostat Kit	Thermostat	56A87	•	•
	Mounting Box	31461	•	•
Refrigerant Line Sets	L15-41-20	L15-41-40	•	•
	L15-41-30	L15-41-50		
	L15-65-30	L15-65-40		•
		L15-65-50		
⁶ Snow Guards	X8782	•	•	•

NOTE - Extremes of operating range are plus 10% and minus 5% of line voltage.

¹ Refrigerant charge sufficient for 15 ft. length of refrigerant lines.

² HACR type breaker or fuse.

³ Refer to National or Canadian Electrical Code manual to determine wire, fuse and disconnect size requirements.

⁴ Remote Outdoor Sensor may be used with an iComfort™-enabled outdoor unit for a secondary (alternate) sensor reading. Sensor may also be used with a conventional outdoor unit.

⁵ Optional for service diagnostics.

⁶ Adds 11-1/2 inches (292 mm) to unit height.

⁷ Compressor Low Ambient Cut-Off and Freezestat are recommended with Low Ambient Kit.

FIELD WIRING

- A - Two Wire Power (see Electrical Data)
- B - Two or Three Wire Power (size to heater capacity)
- C - Twelve Wire Low Voltage 18 ga. minimum
Fourteen Wire Low Voltage with Optional Outdoor Thermostat
- D - Eight Wire Low Voltage 18 ga. minimum - With Conventional Thermostat
Ten Wire Low Voltage - With Conventional Thermostat and Optional Outdoor Thermostat
Four Wire Low Voltage RSBUS (not furnished) 18 ga. minimum - With iComfort Wi-Fi® Thermostat

NOTE - Field Wiring Not Furnished

All wiring must conform to NEC or CEC and local electrical codes.

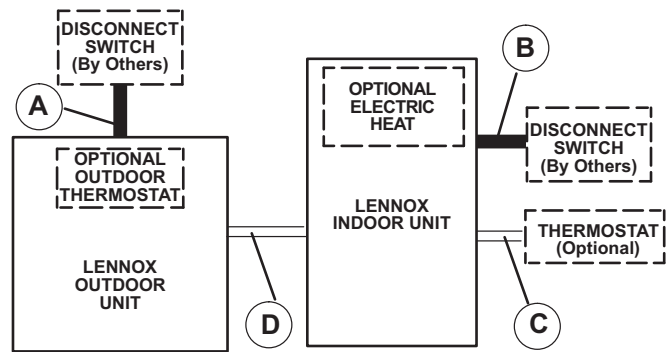

SOUND DATA

¹ Unit Model No.	Octave Band Linear Sound Power Levels dB, re 10 ⁻¹² Watts Center Frequency - HZ							¹ Sound Rating Number (dB)
	125	250	500	1000	2000	4000	8000	
XP17N-024	68	66	65	60	56	50	47	66
XP17N-030	67	64	62	58	55	49	49	67
XP17N-036	71	68	67	61.5	56.5	51	48.5	70

NOTE - the octave sound power data does not include tonal correction.

¹ Tested according to AHRI Standard 270-2008 test conditions.

INSTALLATION CLEARANCES - INCHES (MM)

NOTES:

- One of these three sides must be 36 in. (914 mm).
- One of the two remaining sides may be 12 in. (305 mm).
- The remaining side may be 6 in. (152 mm).
- Service Clearance – 30 in. (762 mm)
- 48 in. (1219 mm) clearance required on top of unit
- 24 in. (610 mm) required between two units

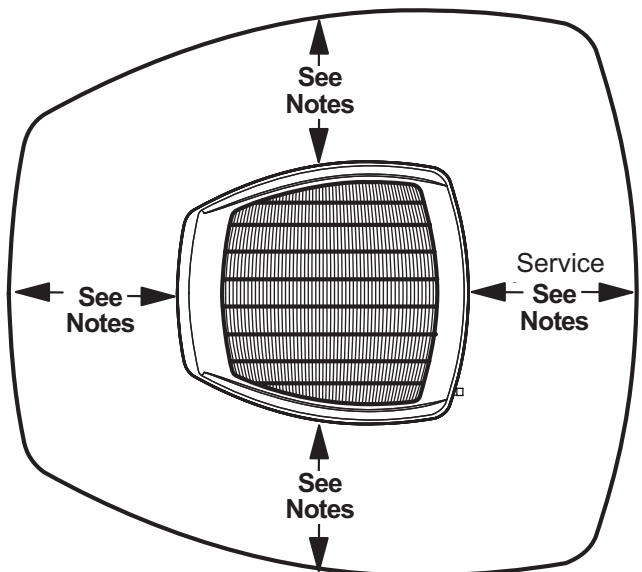

DIMENSIONS - INCHES (MM)

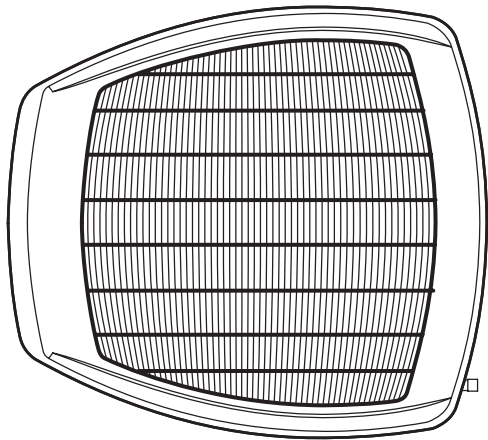

TOP VIEW

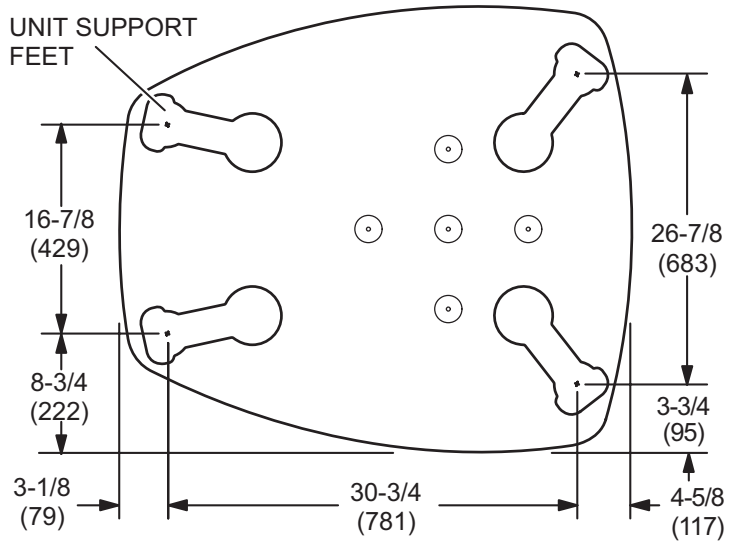

**TOP VIEW BASE SECTION
(Large Base)**

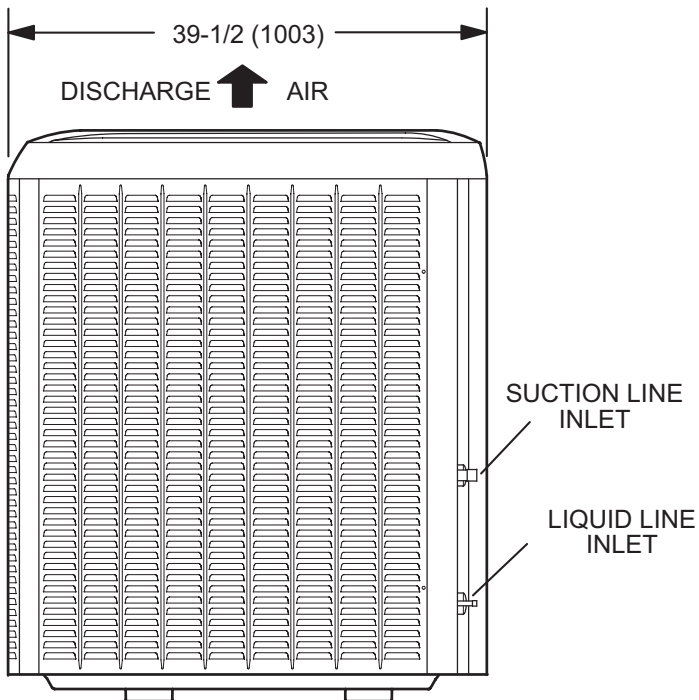

SIDE VIEW

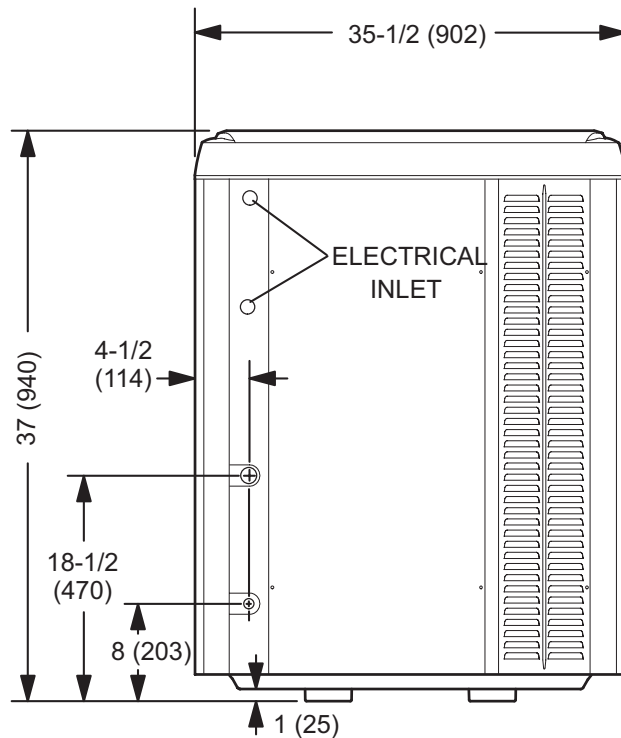

ACCESS VIEW

TXV USAGE

Model No.	Order No.
XP17N-024	49L24
XP17N-030	49L25
XP17N-036	91M02

CX34 upflow coils and all Lennox air handlers are shipped with a factory installed TXV. In most cases, no change out of the valve is needed.

If a change out is required it will be listed in the "TXV SUBSTITUTIONS" table. The correct TXV must be ordered and field installed.

C33 and CH33 coils - Replace the factory installed orifice with the expansion valve listed.

CR33 and CH23 - Use the expansion valve listed.

MOST POPULAR MATCHES

Outdoor Unit Model No.	Indoor Unit Model No
XP17N-024	CBX32MV-024/030
XP17N-030	CBX32MV-024/030
XP17N-036	CBX32MV-048

*TXV SUBSTITUTIONS

Indoor Coils/Air Handlers with factory installed expansion valves that require field replacement

Model No.	Indoor Coil or Air Handler	Factory TXV	Replacement TXV
XP17N-030	CBX27UH-030	49L24	49L25
XP17N-030	CBX27UH-036	49L24	49L25
XP17N-030	CBX32M-030	49L24	49L25
XP17N-030	CBX32M-036	49L24	49L25
XP17N-030	CBX32MV-024/030	49L24	49L25
XP17N-030	CBX32MV-036	49L24	49L25
XP17N-030	CBX40UHV-024	49L24	49L25
XP17N-030	CBX40UHV-030	49L24	49L25
XP17N-030	CBX40UHV-036	49L24	49L25
XP17N-030	CX34-31	49L24	49L25
XP17N-030	CX34-38	49L24	49L25
XP17N-036	CBX27UH-036	49L24	91M02
XP17N-036	CBX32M-036	49L24	91M02
XP17N-036	CBX32MV-036	49L24	91M02
XP17N-036	CBX40UHV-036	49L24	91M02
XP17N-036	CX34-38	49L24	91M02
XP17N-036	CX34-43	49L25	91M02
XP17N-036	CX34-44/48	49L25	91M02

* CX34 coils and all air handlers - The factory installed expansion valve must be replaced with the expansion valve listed (ordered separately).

If the combination is not listed above, the factory installed TXV is used.

AHRI STANDARD 210/240

Cooling or heating capacities are net values, including the effects of blower motor heat, and do not include supplementary heat. Power input is the total power input to the compressor(s) and fan(s), plus any controls and other items required as part of the system for normal operation.

Units which do not have an indoor air-circulating blower furnished as part of the model, i.e., split system with indoor coil only, is established by subtracting from the total cooling capacity 1250 Btu/h per 1,000 cfm, and by adding the same amount to the heating capacity. Total power input for both heating and cooling is increased by 365 W per 1,000 cfm of indoor air circulated.

AHRI SYSTEM MATCHES

Model No.	Cooling Capacity	SEER	EER	Heat Capacity		Heat COP		HSPF (IV)	Coil or Air Handler	Furnace	AHRI Reference
				High	Low	High	Low				
XP17N-024-230	24,000	16.70	13.50	21,400	13,400	3.42	2.52	8.70	C33-31	EL180UH045E36A	5741781
XP17N-024-230	24,000	16.70	13.50	21,400	13,400	3.42	2.52	8.70	C33-31	EL180UH045XE36A	5741852
XP17N-024-230	24,000	17.20	14.00	21,200	13,300	3.46	2.56	8.70	C33-31	EL180UH070E36B	5742078
XP17N-024-230	24,000	17.20	14.00	21,200	13,300	3.46	2.56	8.70	C33-31	EL180UH070XE36B	5742208
XP17N-024-230	23,800	17.00	13.70	21,200	13,300	3.38	2.50	8.70	C33-31	EL195UH045XE36B	5677329
XP17N-024-230	24,000	17.20	13.70	21,200	13,300	3.44	2.54	9.00	C33-31	EL195UH070XE36B	5677330
XP17N-024-230	24,400	17.20	14.20	21,200	13,200	3.62	2.48	9.00	C33-31	EL296DF0070XV36B	5549516
XP17N-024-230	24,000	17.20	14.00	21,200	13,300	3.44	2.56	9.00	C33-31	EL296UH070XV36B	5677301
XP17N-024-230	23,800	16.70	13.50	21,400	13,400	3.36	2.50	8.70	C33-31	O23V3/4-105/120	5677310
XP17N-024-230	24,200	17.50	14.00	21,400	13,300	3.50	2.58	9.00	C33-31	SL280UH070V36A	5677313
XP17N-024-230	24,200	17.50	14.00	21,400	13,300	3.50	2.58	9.00	C33-31	SL280UH070XV36A	5677315
XP17N-024-230	24,200	17.50	14.20	21,200	13,200	3.50	2.56	8.70	C33-31	SL280UH090V36B	5677317
XP17N-024-230	23,800	17.00	13.50	21,200	13,300	3.38	2.50	8.70	C33-31	SL280UH090V48B	5677319
XP17N-024-230	23,800	17.00	13.50	21,200	13,300	3.38	2.50	8.70	C33-31	SL280UH090XV36B	5677321
XP17N-024-230	24,000	17.20	13.70	21,200	13,300	3.48	2.56	9.00	C33-31	SLP98UH070XV36B	5677324
XP17N-024-230	23,600	15.00	12.20	22,000	13,900	3.22	2.36	8.20	C33-31		5677326
XP17N-024-230	23,600	16.20	13.50	21,400	13,600	3.56	2.56	9.00	C33-38	EL180UH045E36A	5741777
XP17N-024-230	23,600	16.20	13.50	21,400	13,600	3.56	2.56	9.00	C33-38	EL180UH045XE36A	5741848
XP17N-024-230	23,600	16.70	13.70	21,400	13,500	3.64	2.60	9.00	C33-38	EL180UH070E36B	5742076
XP17N-024-230	23,600	16.70	13.70	21,400	13,500	3.64	2.60	9.00	C33-38	EL180UH070XE36B	5742198
XP17N-024-230	23,400	16.20	13.50	21,200	13,500	3.56	2.54	8.70	C33-38	EL195UH045XE36B	5549637
XP17N-024-230	23,600	16.50	13.70	21,400	13,600	3.62	2.60	9.00	C33-38	EL195UH070XE36B	5549638
XP17N-024-230	23,600	16.70	13.70	21,400	13,500	3.64	2.60	9.00	C33-38	EL296DF0070XV36B	5549515
XP17N-024-230	23,400	16.20	13.50	21,200	13,500	3.56	2.54	8.70	C33-38	EL296UH045XE36B	5650858
XP17N-024-230	23,600	16.50	13.70	21,400	13,600	3.62	2.60	9.00	C33-38	EL296UH070XE36B	5650857
XP17N-024-230	23,400	15.70	13.00	21,400	13,700	3.48	2.48	8.70	C33-38	O23V2/3-70/90	5549640
XP17N-024-230	23,400	16.20	13.50	21,400	13,600	3.54	2.54	8.70	C33-38	O23V3/4-105/120	5549531
XP17N-024-230	23,800	16.70	14.00	21,400	13,500	3.68	2.62	9.00	C33-38	SL280UH070V36A	5549533
XP17N-024-230	23,800	16.70	14.00	21,400	13,500	3.68	2.62	9.00	C33-38	SL280UH070XV36A	5549535
XP17N-024-230	23,600	17.00	14.00	21,200	13,500	3.68	2.62	9.00	C33-38	SL280UH090V36B	5549537
XP17N-024-230	23,400	16.20	13.50	21,400	13,500	3.56	2.54	9.00	C33-38	SL280UH090V48B	5549541
XP17N-024-230	23,400	16.20	13.50	21,400	13,500	3.56	2.54	9.00	C33-38	SL280UH090XV48B	5549545
XP17N-024-230	23,800	16.70	13.70	21,400	13,500	3.66	2.60	9.20	C33-38	SLP98UH070V36B	5549549
XP17N-024-230	23,200	14.50	12.00	22,000	14,200	3.36	2.40	8.50	C33-38		5549552
XP17N-024-230	24,400	17.20	14.20	22,000	13,500	3.76	2.62	9.20	CBX27UH-024		5549553
XP17N-024-230	24,400	17.00	14.20	22,000	14,000	3.78	2.74	9.50	CBX27UH-030		5549554
XP17N-024-230	24,000	15.70	13.20	22,400	13,900	3.56	2.50	9.00	CBX32M-030		5549555
XP17N-024-230	24,000	15.00	12.70	22,600	14,400	3.56	2.56	8.70	CBX32M-036		5549556
XP17N-024-230	24,800	17.50	14.20	22,200	13,700	3.86	2.66	9.50	CBX32MV-024/030		5549557
XP17N-024-230	24,800	16.70	14.00	22,200	14,200	3.78	2.68	9.50	CBX32MV-036		5550111
XP17N-024-230	24,400	16.50	13.70	22,200	14,100	3.76	2.70	9.50	CBX40UHV-024		5549558
XP17N-024-230	24,400	16.20	13.70	22,200	14,100	3.72	2.68	9.20	CBX40UHV-030		5549559
XP17N-024-230	24,800	16.50	14.00	22,400	14,200	3.84	2.72	9.50	CBX40UHV-036		5549560
XP17N-024-230	24,200	16.70	14.00	21,200	13,200	3.54	2.44	8.70	CH33-31	SL280UH090V48B	5549542
XP17N-024-230	24,200	16.70	14.00	21,200	13,200	3.54	2.44	8.70	CH33-31	SL280UH090XV48B	5549546
XP17N-024-230	24,400	17.20	14.20	21,200	13,200	3.62	2.48	9.00	CH33-31B	EL180UH070XE36B	5742199
XP17N-024-230	24,200	16.70	14.00	21,200	13,200	3.54	2.44	8.70	CH33-31B	EL195UH045XE36B	5549510

NOTES:

Ratings are AHRI certified to AHRI Standard 210/240 (with 25 ft. of connecting refrigerant lines);

- Cooling Ratings - 95°F outdoor air temperature and 80 °F db/67° F wb entering indoor coil air.

- High Temperature Heating Ratings - 47° F db/43° F wb outdoor air temperature and 70 °F db entering indoor coil air.

- Low Temperature Heating Ratings - 17 °F db/15° F wb outdoor air temperature and 70 °F db entering indoor coil air.

All ratings include the use of a blower time delay relay (TDR). All Lennox variable-speed Furnaces and Air Handlers have time delay capabilities. Other Furnaces and Air Handlers may require an optional time delay relay (58M81) for field installation. See furnace or air handler specifications to determine if relay is needed.

Also see TXV Substitution Table at the beginning of the Heat Pump AHRI System Matches section.

When used with gas furnaces, a dual-fuel control, a control system with dual-fuel capabilities (LZP-2 or LZP-4), or a thermostat with dual-fuel capabilities must be used (order separately).

To convert HSPF from Region IV to Region V - Divide by 1.15.

AHRI SYSTEM MATCHES

Model No.	Cooling Capacity	SEER	EER	Heat Capacity		Heat COP		HSPF (IV)	Coil or Air Handler	Furnace	AHRI Reference
				High	Low	High	Low				
XP17N-024-230	24,400	17.00	14.00	21,400	13,300	3.64	2.48	9.00	CH33-31B	EL195UH070XE36B	5549639
XP17N-024-230	24,200	16.70	14.00	21,200	13,200	3.54	2.44	8.70	CH33-31B	EL296UH045XE36B	5650852
XP17N-024-230	24,400	17.00	14.00	21,400	13,300	3.64	2.48	9.00	CH33-31B	EL296UH070XE36B	5650856
XP17N-024-230	24,200	17.20	14.20	21,200	13,200	3.66	2.52	9.00	CH33-31B	SL280UH090V36B	5549538
XP17N-024-230	24,600	17.20	14.20	21,400	13,200	3.68	2.50	9.00	CH33-31B	SLP98UH070V36B	5549642
XP17N-024-230	23,800	15.00	12.50	21,800	13,700	3.32	2.28	8.20	CH33-31B		5549561
XP17N-024-230	24,200	17.00	14.00	21,200	13,200	3.60	2.48	9.00	CH33-42	EL180UH070E36B	5742079
XP17N-024-230	24,200	17.00	14.00	21,200	13,200	3.60	2.48	9.00	CH33-42	EL180UH070XE36B	5742197
XP17N-024-230	24,000	16.70	13.70	21,200	13,200	3.50	2.44	8.70	CH33-42	EL195UH045XE36B	5549511
XP17N-024-230	24,200	17.00	14.00	21,200	13,200	3.58	2.46	8.70	CH33-42	EL195UH070XE36B	5549513
XP17N-024-230	24,000	16.70	13.70	21,200	13,200	3.50	2.44	8.70	CH33-42	EL296UH045XE36B	5650854
XP17N-024-230	24,200	17.00	14.00	21,200	13,200	3.58	2.46	8.70	CH33-42	EL296UH070XE36B	5650853
XP17N-024-230	24,200	17.00	14.20	21,200	13,200	3.58	2.48	8.70	CH33-42	EL296UH070XV36B	5549517
XP17N-024-230	24,200	17.20	14.20	21,200	13,100	3.64	2.50	8.70	CH33-42	SL280UH090V36B	5549539
XP17N-024-230	24,000	16.70	13.70	21,200	13,200	3.50	2.44	8.70	CH33-42	SL280UH090V48B	5549543
XP17N-024-230	24,000	16.70	13.70	21,200	13,200	3.50	2.44	8.70	CH33-42	SL280UH090XV48B	5549547
XP17N-024-230	24,400	17.00	14.20	21,200	13,200	3.60	2.48	9.00	CH33-42	SLP98UH070V36B	5549550
XP17N-024-230	23,600	14.70	12.50	21,800	13,700	3.30	2.28	8.20	CH33-42		5549562
XP17N-024-230	22,400	15.00	12.50	21,600	13,500	3.44	2.40	8.50	CR33-48	EL180DF070E36B	5741564
XP17N-024-230	22,400	15.50	13.00	21,600	13,500	3.38	2.36	8.20	CR33-48	EL195DF045XE36B	5677296
XP17N-024-230	22,600	15.70	13.00	21,800	13,500	3.42	2.38	8.50	CR33-48	EL195DF070XE48B	5677297
XP17N-024-230	24,600	15.50	12.70	21,800	13,600	3.40	2.34	8.50	CR33-48	EL296DF045V36B	5677300
XP17N-024-230	22,400	15.00	12.50	21,800	13,500	3.36	2.34	8.20	CR33-48	SL280DF070V36A	5677312
XP17N-024-230	24,000	15.00	12.50	21,600	13,600	3.44	2.36	8.50	CR33-48	SL280DF090V48B	5677332
XP17N-024-230	22,600	15.70	13.00	21,800	13,500	3.40	2.36	8.50	CR33-48	SLP98DF070XV36B	5677323
XP17N-024-230	22,000	13.70	11.50	22,200	14,000	3.16	2.22	8.00	CR33-48		5677327
XP17N-024-230	24,000	16.70	13.50	21,400	13,400	3.42	2.52	8.70	CX34-31	EL180UH045E36A	5741782
XP17N-024-230	24,000	16.70	13.50	21,400	13,400	3.42	2.52	8.70	CX34-31	EL180UH045XE36A	5741851
XP17N-024-230	24,000	17.20	14.00	21,200	13,300	3.46	2.56	8.70	CX34-31	EL180UH070E36B	5742088
XP17N-024-230	24,000	17.20	14.00	21,200	13,300	3.46	2.56	8.70	CX34-31	EL180UH070XE36B	5742207
XP17N-024-230	23,800	17.00	13.70	21,200	13,300	3.38	2.50	8.70	CX34-31	EL195UH045XE36B	5677298
XP17N-024-230	24,000	17.20	13.70	21,200	13,300	3.44	2.54	9.00	CX34-31	EL195UH070XE36B	5677299
XP17N-024-230	24,000	17.20	14.00	21,200	13,300	3.44	2.56	9.00	CX34-31	EL296UH070XV36B	5677302
XP17N-024-230	23,800	16.70	13.50	21,400	13,400	3.36	2.50	8.70	CX34-31	O23V3/4-105/120	5677311
XP17N-024-230	24,200	17.50	14.00	21,400	13,300	3.50	2.58	9.00	CX34-31	SL280UH070V36A	5677314
XP17N-024-230	24,200	17.50	14.00	21,400	13,300	3.50	2.58	9.00	CX34-31	SL280UH070XV36A	5677316
XP17N-024-230	24,200	17.50	14.20	21,200	13,200	3.50	2.56	8.70	CX34-31	SL280UH090V36B	5677318
XP17N-024-230	23,800	17.00	13.50	21,200	13,300	3.38	2.50	8.70	CX34-31	SL280UH090V48B	5677320
XP17N-024-230	23,800	17.00	13.50	21,200	13,300	3.38	2.50	8.70	CX34-31	SL280UH090XV48B	5677322
XP17N-024-230	24,000	17.20	13.70	21,200	13,300	3.48	2.56	9.00	CX34-31	SLP98UH070XV36B	5677325
XP17N-024-230	23,400	15.00	12.20	22,000	13,800	3.16	2.34	8.20	CX34-31		5677328
XP17N-024-230	23,600	16.20	13.50	21,400	13,600	3.56	2.56	9.00	CX34-38	EL180UH045E36A	5741778
XP17N-024-230	23,600	16.20	13.50	21,400	13,600	3.56	2.56	9.00	CX34-38	EL180UH045XE36A	5741847
XP17N-024-230	23,600	16.70	13.70	21,400	13,500	3.64	2.60	9.00	CX34-38	EL180UH070E36B	5742077
XP17N-024-230	23,600	16.70	13.70	21,400	13,500	3.64	2.60	9.00	CX34-38	EL180UH070XE36B	5742196
XP17N-024-230	23,400	16.20	13.50	21,200	13,500	3.56	2.54	8.70	CX34-38	EL195UH045XE36B	5549512
XP17N-024-230	23,600	16.50	13.70	21,400	13,600	3.62	2.60	9.00	CX34-38	EL195UH070XE36B	5549514

NOTES:

Ratings are AHRI certified to AHRI Standard 210/240 (with 25 ft. of connecting refrigerant lines);

- Cooling Ratings - 95°F outdoor air temperature and 80 °F db/67° F wb entering indoor coil air.
- High Temperature Heating Ratings - 47° F db/43° F wb outdoor air temperature and 70 °F db entering indoor coil air.
- Low Temperature Heating Ratings - 17 °F db/15° F wb outdoor air temperature and 70 °F db entering indoor coil air.

All ratings include the use of a blower time delay relay (TDR). All Lennox variable-speed Furnaces and Air Handlers have time delay capabilities. Other Furnaces and Air Handlers may require an optional time delay relay (58M81) for field installation. See furnace or air handler specifications to determine if relay is needed.

Also see TXV Substitution Table at the beginning of the Heat Pump AHRI System Matches section.

When used with gas furnaces, a dual-fuel control, a control system with dual-fuel capabilities (LZP-2 or LZP-4), or a thermostat with dual-fuel capabilities must be used (order separately).

To convert HSPF from Region IV to Region V - Divide by 1.15.

AHRI SYSTEM MATCHES

Model No.	Cooling Capacity	SEER	EER	Heat Capacity		Heat COP		HSPF (IV)	Coil or Air Handler	Furnace	AHRI Reference
				High	Low	High	Low				
XP17N-024-230	23,400	16.20	13.50	21,200	13,500	3.56	2.54	8.70	CX34-38	EL296UH045XE36B	5650851
XP17N-024-230	23,600	16.50	13.70	21,400	13,600	3.62	2.60	9.00	CX34-38	EL296UH070XE36B	5650855
XP17N-024-230	23,600	16.70	13.70	21,400	13,500	3.64	2.60	9.00	CX34-38	EL296UH070XV36B	5549518
XP17N-024-230	23,400	15.70	13.00	21,400	13,700	3.48	2.48	8.70	CX34-38	O23V2/3-70/90	5549641
XP17N-024-230	23,400	16.20	13.50	21,400	13,600	3.54	2.54	8.70	CX34-38	O23V3/4-105/120	5549532
XP17N-024-230	23,800	16.70	14.00	21,400	13,500	3.68	2.62	9.00	CX34-38	SL280UH070V36A	5549534
XP17N-024-230	23,800	16.70	14.00	21,400	13,500	3.68	2.62	9.00	CX34-38	SL280UH070XV36A	5549536
XP17N-024-230	23,600	17.00	14.00	21,200	13,500	3.68	2.62	9.00	CX34-38	SL280UH090V36B	5549540
XP17N-024-230	23,400	16.20	13.50	21,400	13,500	3.56	2.54	8.70	CX34-38	SL280UH090V48B	5549544
XP17N-024-230	23,400	16.20	13.50	21,400	13,500	3.56	2.54	9.00	CX34-38	SL280UH090XV48B	5549548
XP17N-024-230	23,800	16.70	13.70	21,400	13,500	3.66	2.60	9.20	CX34-38	SLP98UH070XV36B	5549551
XP17N-024-230	23,200	14.50	12.00	22,000	14,200	3.36	2.40	8.50	CX34-38		5549563
XP17N-030-230	28,000	16.00	13.00	25,600	16,800	3.20	2.46	8.50	C33-31	CBWMV-36B-070	5717841
XP17N-030-230	28,800	15.70	13.00	25,600	16,900	3.18	2.44	8.50	C33-31	EL180UH045E36A	5741784
XP17N-030-230	28,800	15.70	13.00	25,600	16,900	3.18	2.44	8.50	C33-31	EL180UH045XE36A	5741853
XP17N-030-230	29,000	16.00	13.00	25,600	16,800	3.24	2.48	8.70	C33-31	EL180UH070E36B	5742092
XP17N-030-230	29,000	16.00	13.00	25,600	16,800	3.24	2.48	8.70	C33-31	EL180UH070XE36B	5742209
XP17N-030-230	29,000	16.00	13.00	25,400	16,700	3.26	2.48	8.70	C33-31	EL180UH090E48B	5742409
XP17N-030-230	29,000	16.00	13.00	25,400	16,700	3.26	2.48	8.70	C33-31	EL180UH090XE48B	5740407
XP17N-030-230	29,000	15.70	13.00	25,600	16,900	3.20	2.44	8.50	C33-31	EL195UH045XE36B	5717843
XP17N-030-230	29,000	16.00	13.00	25,600	17,000	3.24	2.46	8.50	C33-31	EL195UH070XE36B	5717847
XP17N-030-230	29,000	16.00	13.00	25,600	16,800	3.20	2.44	8.50	C33-31	EL296UH045XV36B	5717851
XP17N-030-230	29,000	16.00	13.00	25,600	16,800	3.22	2.46	8.70	C33-31	SL280UH070V36A	5717874
XP17N-030-230	29,000	16.00	13.00	25,600	16,800	3.22	2.46	8.70	C33-31	SL280UH070XV36A	5717876
XP17N-030-230	29,200	16.00	13.00	25,600	16,800	3.26	2.50	8.70	C33-31	SL280UH090V36B	5717878
XP17N-030-230	29,200	16.00	13.00	25,600	16,800	3.30	2.50	8.70	C33-31	SL280UH090V48B	5717882
XP17N-030-230	29,200	16.00	13.00	25,600	16,800	3.30	2.50	8.70	C33-31	SL280UH090XV48B	5717886
XP17N-030-230	29,000	16.00	13.00	25,600	16,800	3.18	2.44	8.50	C33-31	SLP98UH070XV36B	5717890
XP17N-030-230	28,400	14.50	12.00	26,000	17,300	3.04	2.34	8.00	C33-31		5717893
XP17N-030-230	29,000	15.70	13.20	25,600	16,700	3.34	2.40	8.70	C33-38	EL180UH045E36A	5741776
XP17N-030-230	29,000	15.70	13.20	25,600	16,700	3.34	2.40	8.70	C33-38	EL180UH045XE36A	5741846
XP17N-030-230	29,400	16.20	13.70	25,600	16,600	3.44	2.44	8.70	C33-38	EL180UH070E36B	5742072
XP17N-030-230	29,400	16.20	13.70	25,600	16,600	3.44	2.44	8.70	C33-38	EL180UH070XE36B	5742193
XP17N-030-230	29,400	16.20	13.70	25,600	16,600	3.44	2.46	8.70	C33-38	EL180UH090E48B	5742393
XP17N-030-230	29,400	16.20	13.70	25,600	16,600	3.44	2.46	8.70	C33-38	EL180UH090XE48B	5740395
XP17N-030-230	29,200	15.70	13.20	25,800	16,700	3.36	2.40	8.70	C33-38	EL195UH045XE36B	5549432
XP17N-030-230	29,200	16.00	13.20	25,600	16,800	3.40	2.42	8.70	C33-38	EL195UH070XE36B	5549433
XP17N-030-230	29,200	15.70	13.20	25,800	16,700	3.36	2.40	8.70	C33-38	EL296UH045XE36B	5650847
XP17N-030-230	29,200	16.00	13.20	25,600	16,800	3.40	2.42	8.70	C33-38	EL296UH070XE36B	5650843
XP17N-030-230	29,200	16.20	13.50	25,600	16,600	3.34	2.42	8.70	C33-38	EL296UH070XV36B	5549434
XP17N-030-230	29,000	15.00	12.50	25,800	16,900	3.28	2.34	8.50	C33-38	O23V3/4-105/120	5549439
XP17N-030-230	29,200	16.20	13.50	25,600	16,600	3.40	2.42	8.70	C33-38	SL280UH070V36A	5549430
XP17N-030-230	29,200	16.20	13.50	25,600	16,600	3.40	2.42	8.70	C33-38	SL280UH070XV36A	5549431
XP17N-030-230	29,400	16.20	13.70	25,600	16,600	3.46	2.46	8.70	C33-38	SL280UH090V36B	5549607
XP17N-030-230	29,600	16.20	13.70	25,600	16,700	3.44	2.46	8.70	C33-38	SL280UH090V48B	5549440
XP17N-030-230	29,600	16.20	13.70	25,600	16,700	3.44	2.46	8.70	C33-38	SL280UH090XV48B	5549441
XP17N-030-230	29,200	16.20	13.50	25,600	16,600	3.34	2.42	8.70	C33-38	SLP98UH070V36B	5549442

NOTES:

Ratings are AHRI certified to AHRI Standard 210/240 (with 25 ft. of connecting refrigerant lines);

• Cooling Ratings - 95°F outdoor air temperature and 80 °F db/67° F wb entering indoor coil air.

• High Temperature Heating Ratings - 47° F db/43° F wb outdoor air temperature and 70 °F db entering indoor coil air.

• Low Temperature Heating Ratings - 17 °F db/15° F wb outdoor air temperature and 70 °F db entering indoor coil air.

All ratings include the use of a blower time delay relay (TDR). All Lennox variable-speed Furnaces and Air Handlers have time delay capabilities. Other Furnaces and Air Handlers may require an optional time delay relay (58M81) for field installation. See furnace or air handler specifications to determine if relay is needed.

Also see TXV Substitution Table at the beginning of the Heat Pump AHRI System Matches section.

When used with gas furnaces, a dual-fuel control, a control system with dual-fuel capabilities (LZP-2 or LZP-4), or a thermostat with dual-fuel capabilities must be used (order separately).

To convert HSPF from Region IV to Region V - Divide by 1.15.

AHRI SYSTEM MATCHES

Model No.	Cooling Capacity	SEER	EER	Heat Capacity		Heat COP		HSPF (IV)	Coil or Air Handler	Furnace	AHRI Reference
				High	Low	High	Low				
XP17N-030-230	28,800	14.50	12.20	26,200	17,200	3.20	2.30	8.20	C33-38		5549443
XP17N-030-230	29,400	16.50	13.70	25,600	16,600	3.58	2.46	8.70	C33-43	EL180UH070E36B	5742075
XP17N-030-230	29,400	16.50	13.70	25,600	16,600	3.58	2.46	8.70	C33-43	EL180UH070XE36B	5742192
XP17N-030-230	29,400	16.50	13.70	25,600	16,600	3.60	2.46	8.70	C33-43	EL180UH090E48B	5742395
XP17N-030-230	29,400	16.50	13.70	25,600	16,600	3.60	2.46	8.70	C33-43	EL180UH090XE48B	5740393
XP17N-030-230	29,200	16.00	13.20	25,800	16,800	3.52	2.42	8.70	C33-43	EL195UH045XE36B	5549444
XP17N-030-230	29,400	16.00	13.50	25,600	16,800	3.56	2.44	8.70	C33-43	EL195UH070XE36B	5549445
XP17N-030-230	29,200	16.00	13.20	25,800	16,800	3.52	2.42	8.70	C33-43	EL296UH045XE36B	5650844
XP17N-030-230	29,400	16.00	13.50	25,600	16,800	3.56	2.44	8.70	C33-43	EL296UH070XE36B	5650845
XP17N-030-230	29,400	16.20	13.50	25,600	16,600	3.52	2.44	8.70	C33-43	EL296UH070XV36B	5549446
XP17N-030-230	29,600	16.70	14.00	25,600	16,500	3.58	2.46	8.70	C33-43	EL296UH090XV36C	5549456
XP17N-030-230	29,000	15.00	12.50	25,800	17,000	3.42	2.36	8.50	C33-43	O23V3/4-105/120	5549451
XP17N-030-230	29,200	15.00	12.50	25,800	16,800	3.50	2.40	8.50	C33-43	O23V5-140/154	5549457
XP17N-030-230	29,400	16.50	13.70	25,600	16,700	3.58	2.48	8.70	C33-43	SL280UH090V36B	5549608
XP17N-030-230	29,600	16.50	13.70	25,600	16,700	3.62	2.48	8.70	C33-43	SL280UH090V48B	5549452
XP17N-030-230	29,600	16.50	13.70	25,600	16,700	3.62	2.48	8.70	C33-43	SL280UH090XV48B	5549453
XP17N-030-230	29,400	16.20	13.50	25,600	16,600	3.52	2.44	8.70	C33-43	SLP98UH070XV36B	5549454
XP17N-030-230	29,600	16.70	14.00	25,600	16,400	3.56	2.46	8.70	C33-43	SLP98UH090XV36C	5549458
XP17N-030-230	28,800	14.70	12.20	26,200	17,200	3.34	2.30	8.20	C33-43		5549455
XP17N-030-230	29,200	16.20	13.70	26,800	17,300	3.78	2.70	9.00	CBX27UH-030		5549459
XP17N-030-230	29,200	16.50	13.70	26,800	17,200	3.82	2.72	9.00	CBX27UH-036		5549460
XP17N-030-230	28,800	15.20	12.70	27,000	17,500	3.50	2.58	8.70	CBX32M-030		5549461
XP17N-030-230	28,800	15.20	12.70	27,200	17,700	3.62	2.58	8.70	CBX32M-036		5549462
XP17N-030-230	29,000	16.20	13.50	26,800	17,300	3.56	2.62	9.00	CBX32MV-024/030		5549463
XP17N-030-230	29,200	16.20	13.50	26,800	17,300	3.70	2.66	9.00	CBX32MV-036		5549464
XP17N-030-230	29,000	16.20	13.70	26,600	17,200	3.74	2.68	9.00	CBX40UHV-024		5549465
XP17N-030-230	29,200	16.20	13.50	26,800	17,300	3.76	2.70	9.00	CBX40UHV-030		5549466
XP17N-030-230	29,200	16.50	13.70	26,800	17,200	3.80	2.70	9.00	CBX40UHV-036		5549467
XP17N-030-230	29,200	16.00	13.50	25,600	16,800	3.42	2.48	8.50	CH33-31	SLP98UH070XV36B	5717891
XP17N-030-230	29,200	16.00	13.50	25,600	16,800	3.46	2.50	8.70	CH33-31B	EL180UH070E36B	5742091
XP17N-030-230	29,200	16.00	13.50	25,600	16,800	3.46	2.50	8.70	CH33-31B	EL180UH070XE36B	5742210
XP17N-030-230	29,200	16.50	13.50	25,600	16,700	3.48	2.52	8.70	CH33-31B	EL180UH090E48B	5742408
XP17N-030-230	29,200	16.50	13.50	25,600	16,700	3.48	2.52	8.70	CH33-31B	EL180UH090XE48B	5740406
XP17N-030-230	29,200	15.70	13.00	25,800	16,900	3.42	2.48	8.50	CH33-31B	EL195UH045XE36B	5717844
XP17N-030-230	29,200	16.00	13.00	25,600	17,000	3.46	2.48	8.70	CH33-31B	EL195UH070XE36B	5717848
XP17N-030-230	29,200	16.00	13.50	25,600	16,800	3.40	2.48	8.50	CH33-31B	EL296UH045XV36B	5720196
XP17N-030-230	29,400	16.00	13.50	25,600	16,800	3.50	2.52	8.70	CH33-31B	SL280UH090V36B	5717879
XP17N-030-230	29,400	16.00	13.50	25,800	16,800	3.50	2.54	8.70	CH33-31B	SL280UH090V48B	5717883
XP17N-030-230	29,400	16.00	13.50	25,800	16,800	3.50	2.54	8.70	CH33-31B	SL280UH090XV48B	5717887
XP17N-030-230	29,200	14.50	12.20	28,200	18,200	3.24	2.36	8.20	CH33-31B		5717894
XP17N-030-230	29,000	16.00	13.50	25,600	16,800	3.46	2.50	8.70	CH33-42	EL180UH070E36B	5742090
XP17N-030-230	29,000	16.00	13.50	25,600	16,800	3.46	2.50	8.70	CH33-42	EL180UH070XE36B	5742212
XP17N-030-230	29,000	16.00	13.50	25,400	16,700	3.46	2.52	8.70	CH33-42	EL180UH090E48B	5742407
XP17N-030-230	29,000	16.00	13.50	25,400	16,700	3.46	2.52	8.70	CH33-42	EL180UH090XE48B	5740409
XP17N-030-230	29,000	15.70	13.00	25,600	16,900	3.40	2.48	8.50	CH33-42	EL195UH045XE36B	5717845
XP17N-030-230	29,200	15.70	13.00	25,800	17,000	3.46	2.48	8.70	CH33-42	EL195UH070XE36B	5717849
XP17N-030-230	29,200	16.00	13.50	25,600	16,800	3.50	2.50	8.70	CH33-42	SL280UH090V36B	5717880

NOTES:

Ratings are AHRI certified to AHRI Standard 210/240 (with 25 ft. of connecting refrigerant lines);

- Cooling Ratings - 95°F outdoor air temperature and 80 °F db/67° F wb entering indoor coil air.
- High Temperature Heating Ratings - 47° F db/43° F wb outdoor air temperature and 70 °F db entering indoor coil air.
- Low Temperature Heating Ratings - 17 °F db/15° F wb outdoor air temperature and 70 °F db entering indoor coil air.

All ratings include the use of a blower time delay relay (TDR). All Lennox variable-speed Furnaces and Air Handlers have time delay capabilities. Other Furnaces and Air Handlers may require an optional time delay relay (58M81) for field installation. See furnace or air handler specifications to determine if relay is needed.

Also see TXV Substitution Table at the beginning of the Heat Pump AHRI System Matches section.

When used with gas furnaces, a dual-fuel control, a control system with dual-fuel capabilities (LZP-2 or LZP-4), or a thermostat with dual-fuel capabilities must be used (order separately).

To convert HSPF from Region IV to Region V - Divide by 1.15.

AHRI SYSTEM MATCHES

Model No.	Cooling Capacity	SEER	EER	Heat Capacity		Heat COP		HSPF (IV)	Coil or Air Handler	Furnace	AHRI Reference
				High	Low	High	Low				
XP17N-030-230	29,200	16.00	13.50	25,600	16,800	3.50	2.52	8.70	CH33-42	SL280UH090V48B	5717884
XP17N-030-230	29,200	16.00	13.50	25,600	16,800	3.50	2.52	8.70	CH33-42	SL280UH090XV48B	5717888
XP17N-030-230	28,400	14.50	12.20	26,000	17,300	3.22	2.34	8.20	CH33-42		5717895
XP17N-030-230	27,800	15.70	13.00	26,600	17,200	3.64	2.62	8.70	CR33-48	EL180DF070E36B	5741562
XP17N-030-230	27,800	16.50	13.20	28,400	18,400	3.64	2.62	9.20	CR33-48	EL180DF090E48B	5741586
XP17N-030-230	27,600	15.20	12.70	26,800	17,400	3.58	2.58	8.70	CR33-48	EL195DF045XE36B	5549468
XP17N-030-230	27,600	15.20	12.70	26,600	17,400	3.58	2.58	8.70	CR33-48	EL195DF070XE48B	5549469
XP17N-030-230	27,600	15.20	12.70	26,800	17,400	3.58	2.58	8.70	CR33-48	EL296DF045XE36B	5650841
XP17N-030-230	27,400	15.50	12.70	26,600	17,200	3.56	2.58	8.70	CR33-48	EL296DF045XV36B	5549470
XP17N-030-230	27,600	15.20	12.70	26,600	17,400	3.58	2.58	8.70	CR33-48	EL296DF070XE48B	5650848
XP17N-030-230	27,400	15.20	12.70	26,800	17,300	3.56	2.56	8.50	CR33-48	EL296DF070XV48B	5549471
XP17N-030-230	27,600	15.00	12.50	26,800	17,300	3.60	2.60	8.50	CR33-48	SL280DF070V36A	5549609
XP17N-030-230	27,400	15.00	12.50	26,400	17,200	3.54	2.58	8.50	CR33-48	SL280DF090V48B	5549610
XP17N-030-230	27,600	15.50	12.70	26,600	17,200	3.56	2.58	8.70	CR33-48	SLP98DF070XV36B	5549474
XP17N-030-230	27,600	15.70	13.00	26,400	17,100	3.62	2.60	8.70	CR33-48	SLP98DF090XV36C	5549476
XP17N-030-230	27,600	15.70	13.00	26,400	17,100	3.62	2.60	8.70	CR33-48	SLP98DF090XV48C	5549477
XP17N-030-230	27,200	14.00	11.00	27,200	17,800	3.38	2.46	8.20	CR33-48		5549475
XP17N-030-230	28,000	16.00	13.00	25,600	16,800	3.20	2.46	8.50	CX34-31	CBWMV-36B-070	5717842
XP17N-030-230	28,800	15.70	13.00	25,600	16,900	3.18	2.44	8.50	CX34-31	EL180UH045E36A	5741783
XP17N-030-230	28,800	15.70	13.00	25,600	16,900	3.18	2.44	8.50	CX34-31	EL180UH045XE36A	5741854
XP17N-030-230	29,000	16.00	13.00	25,600	16,800	3.24	2.48	8.70	CX34-31	EL180UH070E36B	5742089
XP17N-030-230	29,000	16.00	13.00	25,600	16,800	3.24	2.48	8.70	CX34-31	EL180UH070XE36B	5742211
XP17N-030-230	29,000	16.00	13.00	25,400	16,700	3.26	2.48	8.70	CX34-31	EL180UH090E48B	5742406
XP17N-030-230	29,000	16.00	13.00	25,400	16,700	3.26	2.48	8.70	CX34-31	EL180UH090XE48B	5740408
XP17N-030-230	29,000	15.70	13.00	25,600	16,900	3.20	2.44	8.50	CX34-31	EL195UH045XE36B	5717846
XP17N-030-230	29,000	16.00	13.00	25,600	17,000	3.24	2.46	8.50	CX34-31	EL195UH070XE36B	5717850
XP17N-030-230	29,000	16.00	13.00	25,600	16,800	3.20	2.44	8.50	CX34-31	EL296UH070XV36B	5717853
XP17N-030-230	29,000	16.00	13.00	25,600	16,800	3.22	2.46	8.70	CX34-31	SL280UH070V36A	5717875
XP17N-030-230	29,000	16.00	13.00	25,600	16,800	3.22	2.46	8.70	CX34-31	SL280UH070XV36A	5717877
XP17N-030-230	29,200	16.00	13.00	25,600	16,800	3.26	2.50	8.70	CX34-31	SL280UH090V36B	5717881
XP17N-030-230	29,200	16.00	13.00	25,600	16,800	3.30	2.50	8.70	CX34-31	SL280UH090V48B	5717885
XP17N-030-230	29,200	16.00	13.00	25,600	16,800	3.30	2.50	8.70	CX34-31	SL280UH090XV48B	5717889
XP17N-030-230	29,000	16.00	13.00	25,600	16,800	3.18	2.44	8.50	CX34-31	SLP98UH070XV36B	5717892
XP17N-030-230	28,400	14.50	12.00	26,000	17,300	3.04	2.34	8.00	CX34-31		5717896
XP17N-030-230	29,000	15.70	13.20	25,600	16,700	3.34	2.40	8.70	CX34-38	EL180UH045E36A	5741775
XP17N-030-230	29,000	15.70	13.20	25,600	16,700	3.34	2.40	8.70	CX34-38	EL180UH045XE36A	5741845
XP17N-030-230	29,200	16.20	13.50	25,600	16,600	3.40	2.42	8.70	CX34-38	EL180UH070E36B	5742074
XP17N-030-230	29,200	16.20	13.50	25,600	16,600	3.40	2.42	8.70	CX34-38	EL180UH070XE36B	5742195
XP17N-030-230	29,400	16.20	13.70	25,600	16,600	3.44	2.46	8.70	CX34-38	EL180UH090E48B	5742396
XP17N-030-230	29,400	16.20	13.70	25,600	16,600	3.44	2.46	8.70	CX34-38	EL180UH090XE48B	5740394
XP17N-030-230	29,200	15.70	13.20	25,800	16,700	3.36	2.40	8.70	CX34-38	EL195UH045XE36B	5549482
XP17N-030-230	29,200	16.00	13.20	25,600	16,800	3.40	2.42	8.70	CX34-38	EL195UH070XE36B	5549483
XP17N-030-230	29,200	15.70	13.20	25,800	16,700	3.36	2.40	8.70	CX34-38	EL296UH045XE36B	5650850
XP17N-030-230	29,200	16.00	13.20	25,600	16,800	3.40	2.42	8.70	CX34-38	EL296UH070XE36B	5650846
XP17N-030-230	29,200	16.20	13.50	25,600	16,600	3.34	2.42	8.70	CX34-38	EL296UH070XV36B	5549484
XP17N-030-230	29,000	15.00	12.50	25,800	16,900	3.28	2.34	8.50	CX34-38	O23V3/4-105/120	5549487
XP17N-030-230	29,400	16.20	13.70	25,600	16,600	3.46	2.46	8.70	CX34-38	SL280UH090V36B	5549611

NOTES:

Ratings are AHRI certified to AHRI Standard 210/240 (with 25 ft. of connecting refrigerant lines);

• Cooling Ratings - 95°F outdoor air temperature and 80 °F db/67° F wb entering indoor coil air.

• High Temperature Heating Ratings - 47° F db/43° F wb outdoor air temperature and 70 °F db entering indoor coil air.

• Low Temperature Heating Ratings - 17 °F db/15° F wb outdoor air temperature and 70 °F db entering indoor coil air.

All ratings include the use of a blower time delay relay (TDR). All Lennox variable-speed Furnaces and Air Handlers have time delay capabilities. Other Furnaces and Air Handlers may require an optional time delay relay (58M81) for field installation. See furnace or air handler specifications to determine if relay is needed.

Also see TXV Substitution Table at the beginning of the Heat Pump AHRI System Matches section.

When used with gas furnaces, a dual-fuel control, a control system with dual-fuel capabilities (LZP-2 or LZP-4), or a thermostat with dual-fuel capabilities must be used (order separately).

To convert HSPF from Region IV to Region V - Divide by 1.15.

AHRI SYSTEM MATCHES

Model No.	Cooling Capacity	SEER	EER	Heat Capacity		Heat COP		HSPF (IV)	Coil or Air Handler	Furnace	AHRI Reference
				High	Low	High	Low				
XP17N-030-230	29,600	16.20	13.70	25,600	16,700	3.44	2.46	8.70	CX34-38	SL280UH090V48B	5549488
XP17N-030-230	29,600	16.20	13.70	25,600	16,700	3.44	2.46	8.70	CX34-38	SL280UH090XV48B	5549489
XP17N-030-230	29,200	16.20	13.50	25,600	16,600	3.34	2.42	8.70	CX34-38	SLP98UH070XV36B	5549490
XP17N-030-230	28,800	14.50	12.20	26,200	17,200	3.20	2.30	8.20	CX34-38		5549491
XP17N-030-230	29,400	16.50	13.70	25,600	16,600	3.58	2.46	8.70	CX34-43	EL180UH070E36B	5742073
XP17N-030-230	29,400	16.50	13.70	25,600	16,600	3.58	2.46	8.70	CX34-43	EL180UH070XE36B	5742194
XP17N-030-230	29,400	16.50	13.70	25,600	16,600	3.60	2.46	8.70	CX34-43	EL180UH090E48B	5742394
XP17N-030-230	29,400	16.50	13.70	25,600	16,600	3.60	2.46	8.70	CX34-43	EL180UH090XE48B	5740396
XP17N-030-230	29,200	16.00	13.20	25,800	16,800	3.52	2.42	8.70	CX34-43	EL195UH045XE36B	5549492
XP17N-030-230	29,400	16.00	13.50	25,600	16,800	3.56	2.44	8.70	CX34-43	EL195UH070XE36B	5549493
XP17N-030-230	29,200	16.00	13.20	25,800	16,800	3.52	2.42	8.70	CX34-43	EL296UH045XE36B	5650842
XP17N-030-230	29,400	16.00	13.50	25,600	16,800	3.56	2.44	8.70	CX34-43	EL296UH070XE36B	5650849
XP17N-030-230	29,400	16.20	13.50	25,600	16,600	3.52	2.44	8.70	CX34-43	EL296UH070XV36B	5549494
XP17N-030-230	29,600	16.70	14.00	25,600	16,500	3.58	2.46	8.70	CX34-43	EL296UH090XV36C	5549504
XP17N-030-230	29,000	15.00	12.50	25,800	17,000	3.42	2.36	8.50	CX34-43	O23V3/4-105/120	5549499
XP17N-030-230	29,200	15.00	12.50	25,800	16,800	3.50	2.40	8.50	CX34-43	O23V5-140/154	5549505
XP17N-030-230	29,400	16.50	13.70	25,600	16,700	3.58	2.48	8.70	CX34-43	SL280UH090V36B	5549612
XP17N-030-230	29,600	16.50	13.70	25,600	16,700	3.62	2.48	8.70	CX34-43	SL280UH090V48B	5549500
XP17N-030-230	29,600	16.50	13.70	25,600	16,700	3.62	2.48	8.70	CX34-43	SL280UH090XV48B	5549501
XP17N-030-230	29,400	16.20	13.50	25,600	16,600	3.52	2.44	8.70	CX34-43	SLP98UH070V36B	5549502
XP17N-030-230	29,600	16.70	14.00	25,600	16,400	3.56	2.46	8.70	CX34-43	SLP98UH090XV36C	5549506
XP17N-030-230	28,800	14.70	12.20	26,200	17,000	3.36	2.32	8.20	CX34-43		5549503
XP17N-036-230	35,400	14.70	12.50	31,800	20,000	3.14	2.28	8.00	C33-38	EL180UH045E36A	5741780
XP17N-036-230	35,400	14.70	12.50	31,800	20,000	3.14	2.28	8.00	C33-38	EL180UH045XE36A	5741850
XP17N-036-230	35,200	15.50	13.00	31,200	19,600	3.16	2.32	8.20	C33-38	EL180UH070E36B	5742087
XP17N-036-230	35,200	15.50	13.00	31,200	19,600	3.16	2.32	8.20	C33-38	EL180UH070XE36B	5742203
XP17N-036-230	36,000	15.20	12.70	31,800	20,000	3.24	2.34	8.20	C33-38	EL180UH090E48B	5742399
XP17N-036-230	36,000	15.20	12.70	31,800	20,000	3.24	2.34	8.20	C33-38	EL180UH090XE48B	5740397
XP17N-036-230	35,400	14.20	12.20	32,000	20,400	3.12	2.26	8.00	C33-38	EL195UH045XE36B	5613370
XP17N-036-230	35,400	14.50	12.20	31,400	20,200	3.14	2.28	8.00	C33-38	EL195UH070XE36B	5613377
XP17N-036-230	35,400	14.20	12.20	32,000	20,400	3.12	2.26	8.00	C33-38	EL296UH045XE36B	5650921
XP17N-036-230	35,400	14.50	12.20	31,400	20,200	3.14	2.28	8.00	C33-38	EL296UH070XE36B	5650912
XP17N-036-230	35,400	15.00	12.70	31,400	19,800	3.14	2.28	8.20	C33-38	EL296UH070XV36B	5613406
XP17N-036-230	35,600	15.00	12.50	31,800	20,000	3.20	2.32	8.20	C33-38	SL280UH070V36A	5613529
XP17N-036-230	35,600	15.00	12.50	31,800	20,000	3.20	2.32	8.20	C33-38	SL280UH070XV36A	5613531
XP17N-036-230	35,400	15.50	13.00	31,200	19,600	3.18	2.34	8.20	C33-38	SL280UH090V36B	5613533
XP17N-036-230	35,800	15.50	13.00	31,600	19,800	3.22	2.34	8.20	C33-38	SL280UH090V48B	5613542
XP17N-036-230	35,800	15.50	13.00	31,600	19,800	3.22	2.34	8.20	C33-38	SL280UH090XV48B	5613561
XP17N-036-230	35,400	15.00	12.70	31,400	19,800	3.14	2.28	8.20	C33-38	SLP98UH070XV36B	5613604
XP17N-036-230	35,200	14.00	12.00	32,200	20,400	3.08	2.24	8.00	C33-38		5613642
XP17N-036-230	35,600	15.70	13.00	31,200	19,600	3.30	2.38	8.20	C33-43	EL180UH070E36B	5742081
XP17N-036-230	36,200	15.50	13.00	31,800	20,000	3.36	2.40	8.50	C33-43	EL180UH090E48B	5742402
XP17N-036-230	36,200	15.70	13.20	31,600	19,800	3.38	2.42	8.50	C33-43	EL180UH090E60C	5740275
XP17N-036-230	36,800	15.50	13.00	31,800	20,200	3.36	2.40	8.50	C33-43	EL180UH090XE48B	5740405
XP17N-036-230	36,000	15.70	13.20	31,400	19,700	3.36	2.40	8.50	C33-43	EL180UH110E60C	5740736
XP17N-036-230	36,000	15.70	13.20	31,400	19,700	3.36	2.40	8.50	C33-43	EL180UH110XE60C	5740944
XP17N-036-230	35,800	14.50	12.20	32,000	20,400	3.22	2.32	8.20	C33-43	EL195UH045XE36B	5613371

NOTES:

Ratings are AHRI certified to AHRI Standard 210/240 (with 25 ft. of connecting refrigerant lines);

- Cooling Ratings - 95°F outdoor air temperature and 80 °F db/67° F wb entering indoor coil air.
- High Temperature Heating Ratings - 47° F db/43° F wb outdoor air temperature and 70 °F db entering indoor coil air.
- Low Temperature Heating Ratings - 17 °F db/15° F wb outdoor air temperature and 70 °F db entering indoor coil air.

All ratings include the use of a blower time delay relay (TDR). All Lennox variable-speed Furnaces and Air Handlers have time delay capabilities. Other Furnaces and Air Handlers may require an optional time delay relay (58M81) for field installation. See furnace or air handler specifications to determine if relay is needed.

Also see TXV Substitution Table at the beginning of the Heat Pump AHRI System Matches section.

When used with gas furnaces, a dual-fuel control, a control system with dual-fuel capabilities (LZP-2 or LZP-4), or a thermostat with dual-fuel capabilities must be used (order separately).

To convert HSPF from Region IV to Region V - Divide by 1.15.

AHRI SYSTEM MATCHES

Model No.	Cooling Capacity	SEER	EER	Heat Capacity		Heat COP		HSPF (IV)	Coil or Air Handler	Furnace	AHRI Reference
				High	Low	High	Low				
XP17N-036-230	35,600	14.70	12.20	31,400	20,200	3.24	2.32	8.20	C33-43	EL195UH070XE36B	5613378
XP17N-036-230	35,800	15.50	13.00	31,400	19,800	3.34	2.38	8.50	C33-43	EL195UH090XE48C	5613384
XP17N-036-230	36,400	15.70	13.20	31,600	19,900	3.40	2.42	8.50	C33-43	EL195UH110XE60C	5613394
XP17N-036-230	35,800	14.50	12.20	32,000	20,400	3.22	2.32	8.20	C33-43	EL296UH045XE36B	5650931
XP17N-036-230	35,600	14.70	12.20	31,400	20,200	3.24	2.32	8.20	C33-43	EL296UH070XE36B	5650922
XP17N-036-230	35,600	15.20	12.70	31,400	19,800	3.26	2.36	8.20	C33-43	EL296UH070XV36B	5613407
XP17N-036-230	35,800	15.50	13.00	31,400	19,800	3.34	2.38	8.50	C33-43	EL296UH090XE48C	5650906
XP17N-036-230	35,600	15.50	13.00	31,200	19,600	3.28	2.38	8.20	C33-43	EL296UH090XV36C	5613415
XP17N-036-230	35,800	15.70	13.00	31,400	19,700	3.32	2.40	8.50	C33-43	EL296UH090XV48C	5613425
XP17N-036-230	36,400	15.70	13.20	31,600	19,900	3.40	2.42	8.50	C33-43	EL296UH110XE60C	5650924
XP17N-036-230	36,400	15.70	13.20	31,600	19,900	3.40	2.42	8.50	C33-43	EL296UH110XV48C	5613435
XP17N-036-230	36,400	15.70	13.20	31,600	19,900	3.42	2.44	8.70	C33-43	EL296UH110XV60C	5613445
XP17N-036-230	35,800	15.70	13.20	31,200	19,600	3.32	2.40	8.50	C33-43	SL280UH090V36B	5613534
XP17N-036-230	36,000	15.70	13.20	31,400	19,800	3.36	2.40	8.50	C33-43	SL280UH090V48B	5613543
XP17N-036-230	36,600	15.70	13.20	31,800	19,900	3.44	2.44	8.70	C33-43	SL280UH090V60C	5613551
XP17N-036-230	36,000	15.70	13.20	31,400	19,800	3.36	2.40	8.50	C33-43	SL280UH090XV48B	5613562
XP17N-036-230	36,600	15.70	13.20	31,800	19,900	3.44	2.44	8.70	C33-43	SL280UH090XV60C	5613570
XP17N-036-230	36,400	15.50	13.20	31,600	20,000	3.38	2.42	8.50	C33-43	SL280UH110V60C	5613580
XP17N-036-230	36,400	15.50	13.20	31,600	20,000	3.38	2.42	8.50	C33-43	SL280UH110XV60C	5613590
XP17N-036-230	35,600	15.20	12.70	31,400	19,800	3.26	2.36	8.20	C33-43	SLP98UH070XV36B	5613605
XP17N-036-230	35,600	15.50	13.00	31,200	19,600	3.28	2.38	8.20	C33-43	SLP98UH090XV36C	5613613
XP17N-036-230	35,800	15.70	13.00	31,400	19,700	3.32	2.40	8.50	C33-43	SLP98UH090XV48C	5613623
XP17N-036-230	36,400	15.70	13.20	31,600	19,900	3.42	2.44	8.70	C33-43	SLP98UH110XV60C	5613632
XP17N-036-230	35,400	14.20	12.00	32,000	20,400	3.18	2.26	8.00	C33-43		5613643
XP17N-036-230	34,000	14.70	12.20	30,800	19,500	2.88	2.34	8.20	C33-48	EL180UH070E36B	5742108
XP17N-036-230	34,000	14.70	12.20	31,600	21,000	2.88	2.34	8.20	C33-48	EL180UH070XE36B	5742200
XP17N-036-230	34,600	14.50	12.20	31,600	19,900	2.96	2.38	8.20	C33-48	EL180UH090E48B	5742404
XP17N-036-230	34,400	14.70	12.20	31,200	19,700	2.94	2.36	8.20	C33-48	EL180UH090E60C	5740278
XP17N-036-230	34,600	14.50	12.20	32,000	21,400	2.96	2.38	8.20	C33-48	EL180UH090XE48B	5740401
XP17N-036-230	34,200	14.70	12.20	31,000	19,500	2.88	2.34	8.20	C33-48	EL180UH110E60C	5740730
XP17N-036-230	34,200	14.70	12.20	31,000	19,500	2.88	2.34	8.20	C33-48	EL180UH110XE60C	5740939
XP17N-036-230	34,200	14.50	12.20	31,000	19,700	2.90	2.34	8.20	C33-48	EL195UH090XE48C	5613385
XP17N-036-230	34,600	14.70	12.20	31,400	19,800	2.94	2.36	8.20	C33-48	EL195UH110XE60C	5613395
XP17N-036-230	34,000	14.50	12.20	31,000	19,700	2.88	2.32	8.00	C33-48	EL296UH070XV36B	5613408
XP17N-036-230	34,200	14.50	12.20	31,000	19,700	2.90	2.34	8.20	C33-48	EL296UH090XE48C	5650913
XP17N-036-230	34,000	14.70	12.20	30,800	19,500	2.88	2.32	8.20	C33-48	EL296UH090XV36C	5613416
XP17N-036-230	34,400	14.70	12.50	31,000	19,600	2.92	2.38	8.20	C33-48	EL296UH090XV48C	5613426
XP17N-036-230	34,600	14.70	12.20	31,400	19,800	2.94	2.36	8.20	C33-48	EL296UH110XE60C	5650934
XP17N-036-230	34,800	14.70	12.50	31,400	19,800	3.00	2.38	8.20	C33-48	EL296UH110XV48C	5613436
XP17N-036-230	34,800	14.70	12.50	31,400	19,800	3.02	2.38	8.50	C33-48	EL296UH110XV60C	5613446
XP17N-036-230	34,200	14.70	12.50	31,000	19,500	2.92	2.36	8.20	C33-48	SL280UH090V36B	5613535
XP17N-036-230	34,600	14.70	12.50	31,200	19,700	2.96	2.38	8.20	C33-48	SL280UH090V48B	5613544
XP17N-036-230	35,000	15.00	12.50	31,400	19,800	3.04	2.42	8.50	C33-48	SL280UH090V60C	5613552
XP17N-036-230	34,600	14.70	12.50	31,200	19,700	2.96	2.38	8.20	C33-48	SL280UH090XV48B	5613563
XP17N-036-230	35,000	15.00	12.50	31,400	19,800	3.04	2.42	8.50	C33-48	SL280UH090XV60C	5613571
XP17N-036-230	34,600	14.70	12.20	31,400	19,900	2.98	2.40	8.20	C33-48	SL280UH110V60C	5613581
XP17N-036-230	34,600	14.70	12.20	31,400	19,900	2.98	2.40	8.20	C33-48	SL280UH110XV60C	5613591

NOTES:

Ratings are AHRI certified to AHRI Standard 210/240 (with 25 ft. of connecting refrigerant lines);

• Cooling Ratings - 95°F outdoor air temperature and 80 °F db/67° F wb entering indoor coil air.

• High Temperature Heating Ratings - 47° F db/43° F wb outdoor air temperature and 70 °F db entering indoor coil air.

• Low Temperature Heating Ratings - 17 °F db/15° F wb outdoor air temperature and 70 °F db entering indoor coil air.

All ratings include the use of a blower time delay relay (TDR). All Lennox variable-speed Furnaces and Air Handlers have time delay capabilities. Other Furnaces and Air Handlers may require an optional time delay relay (58M81) for field installation. See furnace or air handler specifications to determine if relay is needed.

Also see TXV Substitution Table at the beginning of the Heat Pump AHRI System Matches section.

When used with gas furnaces, a dual-fuel control, a control system with dual-fuel capabilities (LZP-2 or LZP-4), or a thermostat with dual-fuel capabilities must be used (order separately).

To convert HSPF from Region IV to Region V - Divide by 1.15.

AHRI SYSTEM MATCHES

Model No.	Cooling Capacity	SEER	EER	Heat Capacity		Heat COP		HSPF (IV)	Coil or Air Handler	Furnace	AHRI Reference
				High	Low	High	Low				
XP17N-036-230	34,000	14.50	12.20	31,000	19,700	2.88	2.32	8.00	C33-48	SLP98UH070XV36B	5613606
XP17N-036-230	34,000	14.70	12.20	30,800	19,500	2.88	2.32	8.20	C33-48	SLP98UH090XV36C	5613614
XP17N-036-230	34,400	14.70	12.50	31,000	19,600	2.92	2.38	8.20	C33-48	SLP98UH090XV48C	5613624
XP17N-036-230	34,800	14.70	12.50	31,400	19,800	3.02	2.38	8.50	C33-48	SLP98UH110XV60C	5613633
XP17N-036-230	34,000	13.00	11.00	31,800	20,400	2.82	2.26	8.00	C33-48		5613644
XP17N-036-230	36,200	15.20	13.00	31,600	19,900	3.44	2.40	8.50	C33-49	EL180UH090E60C	5740269
XP17N-036-230	35,800	15.50	13.00	31,200	19,700	3.36	2.36	8.50	C33-49	EL180UH110E60C	5740726
XP17N-036-230	35,800	15.50	13.00	31,200	19,700	3.36	2.36	8.50	C33-49	EL180UH110XE60C	5740936
XP17N-036-230	36,000	15.20	13.00	31,400	19,900	3.44	2.40	8.50	C33-49	EL195UH090XE48C	5549384
XP17N-036-230	36,600	15.50	13.00	31,600	19,900	3.48	2.42	8.70	C33-49	EL195UH110XE60C	5549386
XP17N-036-230	36,000	15.20	13.00	31,400	19,900	3.44	2.40	8.50	C33-49	EL296UH090XE48C	5650840
XP17N-036-230	35,800	15.20	13.00	31,200	19,700	3.36	2.36	8.50	C33-49	EL296UH090XV36C	5549388
XP17N-036-230	36,000	15.50	13.00	31,400	19,800	3.42	2.38	8.50	C33-49	EL296UH090XV48C	5549390
XP17N-036-230	36,600	15.50	13.00	31,600	19,900	3.48	2.42	8.70	C33-49	EL296UH110XE60C	5650838
XP17N-036-230	37,400	15.50	13.00	31,600	20,200	3.48	2.42	8.70	C33-49	EL296UH110XV48C	5549392
XP17N-036-230	36,600	15.50	13.00	31,600	20,000	3.50	2.42	8.70	C33-49	EL296UH110XV60C	5549394
XP17N-036-230	36,800	15.50	13.20	31,600	20,000	3.50	2.44	8.70	C33-49	SL280UH090V60C	5549402
XP17N-036-230	36,800	15.50	13.20	31,600	20,000	3.50	2.44	8.70	C33-49	SL280UH090XV60C	5549404
XP17N-036-230	36,600	15.50	13.00	31,600	20,000	3.46	2.40	8.50	C33-49	SL280UH110V60C	5549406
XP17N-036-230	36,600	15.50	13.00	31,600	20,000	3.46	2.40	8.50	C33-49	SL280UH110XV60C	5549408
XP17N-036-230	35,800	15.20	13.00	31,200	19,700	3.36	2.36	8.50	C33-49	SLP98UH090XV36C	5549410
XP17N-036-230	36,000	15.50	13.00	31,400	19,800	3.42	2.38	8.50	C33-49	SLP98UH090XV48C	5549412
XP17N-036-230	36,600	15.50	13.00	31,600	20,000	3.50	2.42	8.70	C33-49	SLP98UH110XV60C	5549414
XP17N-036-230	35,800	14.00	12.00	32,200	20,600	3.28	2.28	8.20	C33-49		5549416
XP17N-036-230	35,800	15.50	13.00	31,400	19,800	3.34	2.38	8.50	C33-50/60C	EL180UH090E60C	5740271
XP17N-036-230	35,400	15.50	13.00	31,200	19,600	3.28	2.36	8.20	C33-50/60C	EL180UH110E60C	5740733
XP17N-036-230	35,400	15.50	13.00	31,200	19,600	3.28	2.36	8.20	C33-50/60C	EL180UH110XE60C	5740941
XP17N-036-230	35,600	15.50	13.00	31,200	19,800	3.34	2.38	8.50	C33-50/60C	EL195UH090XE48C	5613386
XP17N-036-230	36,200	15.50	13.00	31,600	19,900	3.36	2.42	8.50	C33-50/60C	EL195UH110XE60C	5613396
XP17N-036-230	35,600	15.50	13.00	31,200	19,800	3.34	2.38	8.50	C33-50/60C	EL296UH090XE48C	5650923
XP17N-036-230	35,400	15.50	13.00	31,200	19,600	3.26	2.36	8.20	C33-50/60C	EL296UH090XV36C	5613417
XP17N-036-230	35,600	15.50	13.00	31,200	19,700	3.32	2.40	8.50	C33-50/60C	EL296UH090XV48C	5613427
XP17N-036-230	36,200	15.50	13.00	31,600	19,900	3.36	2.42	8.50	C33-50/60C	EL296UH110XE60C	5650908
XP17N-036-230	36,200	15.50	13.00	31,600	19,900	3.38	2.42	8.50	C33-50/60C	EL296UH110XV48C	5613437
XP17N-036-230	36,200	15.70	13.20	31,600	19,900	3.40	2.44	8.50	C33-50/60C	EL296UH110XV60C	5613447
XP17N-036-230	36,400	15.70	13.20	31,600	19,900	3.42	2.44	8.70	C33-50/60C	SL280UH090V60C	5613553
XP17N-036-230	36,400	15.70	13.20	31,600	19,900	3.42	2.44	8.70	C33-50/60C	SL280UH090XV60C	5613572
XP17N-036-230	36,200	15.50	13.00	31,600	19,900	3.36	2.40	8.50	C33-50/60C	SL280UH110V60C	5613582
XP17N-036-230	36,200	15.50	13.00	31,600	19,900	3.36	2.40	8.50	C33-50/60C	SL280UH110XV60C	5613592
XP17N-036-230	35,400	15.50	13.00	31,200	19,600	3.26	2.36	8.20	C33-50/60C	SLP98UH090XV36C	5613615
XP17N-036-230	35,600	15.50	13.00	31,200	19,700	3.32	2.40	8.50	C33-50/60C	SLP98UH090XV48C	5613625
XP17N-036-230	36,200	15.70	13.20	31,600	19,900	3.40	2.44	8.50	C33-50/60C	SLP98UH110XV60C	5613634
XP17N-036-230	35,400	14.20	12.00	32,000	20,400	3.16	2.26	8.00	C33-50/60C		5613645
XP17N-036-230	35,400	15.50	12.70	32,400	20,400	3.46	2.52	8.70	CBX27UH-036		5549417
XP17N-036-230	36,800	16.20	13.50	32,400	20,400	3.76	2.72	9.20	CBX27UH-042		5549418
XP17N-036-230	35,000	14.50	12.00	33,000	21,000	3.32	2.42	8.50	CBX32M-036		5549419
XP17N-036-230	35,000	14.50	12.00	33,000	21,000	3.32	2.42	8.50	CBX32M-042		5549420

NOTES:

Ratings are AHRI certified to AHRI Standard 210/240 (with 25 ft. of connecting refrigerant lines);

- Cooling Ratings - 95°F outdoor air temperature and 80 °F db/67° F wb entering indoor coil air.
- High Temperature Heating Ratings - 47° F db/43° F wb outdoor air temperature and 70 °F db entering indoor coil air.
- Low Temperature Heating Ratings - 17 °F db/15° F wb outdoor air temperature and 70 °F db entering indoor coil air.

All ratings include the use of a blower time delay relay (TDR). All Lennox variable-speed Furnaces and Air Handlers have time delay capabilities. Other Furnaces and Air Handlers may require an optional time delay relay (58M81) for field installation. See furnace or air handler specifications to determine if relay is needed.

Also see TXV Substitution Table at the beginning of the Heat Pump AHRI System Matches section.

When used with gas furnaces, a dual-fuel control, a control system with dual-fuel capabilities (LZP-2 or LZP-4), or a thermostat with dual-fuel capabilities must be used (order separately).

To convert HSPF from Region IV to Region V - Divide by 1.15.

AHRI SYSTEM MATCHES

Model No.	Cooling Capacity	SEER	EER	Heat Capacity		Heat COP		HSPF (IV)	Coil or Air Handler	Furnace	AHRI Reference
				High	Low	High	Low				
XP17N-036-230	36,200	14.70	12.50	33,000	21,000	3.58	2.60	8.70	CBX32M-048		5549421
XP17N-036-230	35,400	15.20	12.70	32,600	20,600	3.40	2.50	8.70	CBX32MV-036		5549422
XP17N-036-230	37,000	16.50	13.50	32,600	20,400	3.76	2.74	9.20	CBX32MV-048		5549423
XP17N-036-230	35,600	15.50	12.70	32,600	20,600	3.46	2.52	8.70	CBX40UHV-036		5549424
XP17N-036-230	36,800	16.00	13.20	32,400	20,400	3.72	2.70	9.20	CBX40UHV-042		5549425
XP17N-036-230	36,800	16.00	13.50	32,400	20,400	3.74	2.70	9.20	CBX40UHV-048		5549426
XP17N-036-230	34,800	15.20	12.70	31,000	19,600	2.98	2.22	7.70	CH33-42	EL180UH070E36B	5742086
XP17N-036-230	35,000	15.20	12.70	33,600	20,800	2.98	2.22	7.70	CH33-42	EL180UH070XE36B	5742206
XP17N-036-230	35,600	15.00	12.70	31,800	20,000	3.08	2.26	8.00	CH33-42	EL180UH090E48B	5742397
XP17N-036-230	35,800	15.00	12.70	34,000	21,200	3.08	2.26	8.00	CH33-42	EL180UH090XE48B	5740403
XP17N-036-230	35,000	14.20	12.00	32,000	20,400	2.94	2.18	7.70	CH33-42	EL195UH045XE36B	5613372
XP17N-036-230	34,800	14.20	12.00	31,400	20,200	2.96	2.18	7.70	CH33-42	EL195UH070XE36B	5613379
XP17N-036-230	35,000	14.20	12.00	32,000	20,400	2.94	2.18	7.70	CH33-42	EL296UH045XE36B	5650901
XP17N-036-230	34,800	14.20	12.00	31,400	20,200	2.96	2.18	7.70	CH33-42	EL296UH070XE36B	5650932
XP17N-036-230	34,800	14.70	12.50	31,400	19,800	2.94	2.20	7.70	CH33-42	EL296UH070XV36B	5613409
XP17N-036-230	35,000	15.20	12.70	31,200	19,600	3.00	2.24	8.00	CH33-42	SL280UH090V36B	5613536
XP17N-036-230	35,400	15.20	12.70	31,400	19,800	3.06	2.26	8.00	CH33-42	SL280UH090V48B	5613545
XP17N-036-230	35,400	15.20	12.70	31,400	19,800	3.06	2.26	8.00	CH33-42	SL280UH090XV48B	5613564
XP17N-036-230	34,800	14.70	12.50	31,400	19,800	2.94	2.20	7.70	CH33-42	SLP98UH070XV36B	5613607
XP17N-036-230	34,800	14.00	11.70	32,000	20,400	2.90	2.14	7.70	CH33-42		5613646
XP17N-036-230	36,000	16.00	13.20	31,400	19,700	3.44	2.48	8.50	CH33-43	EL180UH070E36B	5742085
XP17N-036-230	37,000	16.00	13.50	31,800	20,800	3.44	2.48	8.70	CH33-43	EL180UH070XE36B	5742202
XP17N-036-230	36,800	16.00	13.00	32,000	20,200	3.52	2.50	8.70	CH33-43	EL180UH090E48B	5742405
XP17N-036-230	36,200	15.70	13.20	31,600	19,800	3.46	2.48	8.50	CH33-43	EL180UH090E60C	5740280
XP17N-036-230	37,800	16.00	13.20	32,200	21,200	3.52	2.50	9.00	CH33-43	EL180UH090XE48B	5740399
XP17N-036-230	36,000	15.70	13.20	31,400	19,700	3.42	2.48	8.50	CH33-43	EL180UH110E60C	5740728
XP17N-036-230	36,000	15.70	13.20	31,400	19,700	3.42	2.48	8.50	CH33-43	EL180UH110XE60C	5740943
XP17N-036-230	36,000	15.70	12.70	31,600	19,900	3.40	2.46	8.50	CH33-43	EL296UH070XV36B	5613410
XP17N-036-230	35,600	15.50	13.00	31,200	19,600	3.36	2.44	8.20	CH33-43	EL296UH090XV36C	5613418
XP17N-036-230	35,800	15.70	13.00	31,400	19,700	3.40	2.46	8.50	CH33-43	EL296UH090XV48C	5613428
XP17N-036-230	36,400	15.70	13.20	31,600	19,900	3.50	2.50	8.70	CH33-43	EL296UH110XV60C	5613448
XP17N-036-230	36,000	15.70	12.70	31,600	19,900	3.40	2.46	8.50	CH33-43	SLP98UH070XV36B	5613608
XP17N-036-230	35,600	15.50	13.00	31,200	19,600	3.36	2.44	8.20	CH33-43	SLP98UH090XV36C	5613616
XP17N-036-230	35,800	15.70	13.00	31,400	19,700	3.40	2.46	8.50	CH33-43	SLP98UH090XV48C	5613626
XP17N-036-230	36,400	15.70	13.20	31,600	19,900	3.50	2.50	8.70	CH33-43	SLP98UH110XV60C	5613635
XP17N-036-230	36,200	15.00	12.50	32,200	20,400	3.36	2.42	8.20	CH33-43B	EL195UH045XE36B	5613373
XP17N-036-230	36,000	15.20	12.50	31,600	20,400	3.38	2.42	8.50	CH33-43B	EL195UH070XE36B	5613380
XP17N-036-230	35,800	15.50	13.00	31,400	19,800	3.42	2.46	8.50	CH33-43B	EL195UH090XE48C	5613387
XP17N-036-230	36,200	15.70	13.00	31,600	19,900	3.46	2.50	8.50	CH33-43B	EL195UH110XE60C	5613397
XP17N-036-230	36,200	15.00	12.50	32,200	20,400	3.36	2.42	8.20	CH33-43B	EL296UH045XE36B	5650935
XP17N-036-230	36,000	15.20	12.50	31,600	20,400	3.38	2.42	8.50	CH33-43B	EL296UH070XE36B	5650902
XP17N-036-230	35,800	15.50	13.00	31,400	19,800	3.42	2.46	8.50	CH33-43B	EL296UH090XE48C	5650933
XP17N-036-230	36,200	15.70	13.00	31,600	19,900	3.46	2.50	8.50	CH33-43B	EL296UH110XE60C	5650938
XP17N-036-230	36,200	16.20	13.20	31,400	19,700	3.48	2.50	8.70	CH33-43B	SL280UH090V36B	5613537
XP17N-036-230	36,600	16.20	13.20	31,800	19,900	3.52	2.52	8.70	CH33-43B	SL280UH090V48B	5613546
XP17N-036-230	36,600	16.20	13.20	31,800	19,900	3.52	2.52	8.70	CH33-43B	SL280UH090XV48B	5613565
XP17N-036-230	36,000	14.70	12.20	32,400	20,600	3.30	2.38	8.20	CH33-43B		5613647

NOTES:

Ratings are AHRI certified to AHRI Standard 210/240 (with 25 ft. of connecting refrigerant lines);

• Cooling Ratings - 95°F outdoor air temperature and 80 °F db/67° F wb entering indoor coil air.

• High Temperature Heating Ratings - 47° F db/43° F wb outdoor air temperature and 70 °F db entering indoor coil air.

• Low Temperature Heating Ratings - 17 °F db/15° F wb outdoor air temperature and 70 °F db entering indoor coil air.

All ratings include the use of a blower time delay relay (TDR). All Lennox variable-speed Furnaces and Air Handlers have time delay capabilities. Other Furnaces and Air Handlers may require an optional time delay relay (58M81) for field installation. See furnace or air handler specifications to determine if relay is needed.

Also see TXV Substitution Table at the beginning of the Heat Pump AHRI System Matches section.

When used with gas furnaces, a dual-fuel control, a control system with dual-fuel capabilities (LZP-2 or LZP-4), or a thermostat with dual-fuel capabilities must be used (order separately).

To convert HSPF from Region IV to Region V - Divide by 1.15.

AHRI SYSTEM MATCHES

Model No.	Cooling Capacity	SEER	EER	Heat Capacity		Heat COP		HSPF (IV)	Coil or Air Handler	Furnace	AHRI Reference
				High	Low	High	Low				
XP17N-036-230	36,200	15.70	13.00	31,400	19,800	3.48	2.50	8.50	CH33-43C	EL296UH110XV48C	5613438
XP17N-036-230	36,600	15.70	13.20	31,800	19,900	3.50	2.52	8.70	CH33-43C	SL280UH090V60C	5613554
XP17N-036-230	36,600	15.70	13.20	31,800	19,900	3.50	2.52	8.70	CH33-43C	SL280UH090XV60C	5613573
XP17N-036-230	36,400	15.50	13.00	31,600	20,000	3.46	2.48	8.50	CH33-43C	SL280UH110V60C	5613583
XP17N-036-230	36,400	15.50	13.00	31,600	20,000	3.46	2.48	8.50	CH33-43C	SL280UH110XV60C	5613593
XP17N-036-230	35,600	14.20	12.00	32,000	20,400	3.24	2.34	8.20	CH33-43C		5613648
XP17N-036-230	35,200	15.50	13.00	31,200	19,600	3.34	2.40	8.50	CH33-44/48	EL180UH070E36B	5742083
XP17N-036-230	36,000	15.20	12.70	31,800	20,000	3.42	2.42	8.50	CH33-44/48	EL180UH090E48B	5742401
XP17N-036-230	36,400	15.20	12.70	33,000	20,800	3.42	2.42	8.50	CH33-44/48	EL180UH090XE48B	5740400
XP17N-036-230	35,400	14.50	12.20	32,000	20,400	3.28	2.34	8.20	CH33-44/48	EL195UH045XE36B	5613374
XP17N-036-230	35,200	14.50	12.20	31,600	20,200	3.30	2.34	8.20	CH33-44/48	EL195UH070XE36B	5613381
XP17N-036-230	35,400	14.50	12.20	32,000	20,400	3.28	2.34	8.20	CH33-44/48	EL296UH045XE36B	5650915
XP17N-036-230	35,200	14.50	12.20	31,600	20,200	3.30	2.34	8.20	CH33-44/48	EL296UH070XE36B	5650936
XP17N-036-230	35,200	15.00	12.70	31,600	19,900	3.30	2.38	8.20	CH33-44/48	EL296UH070XV36B	5613411
XP17N-036-230	35,400	15.50	13.00	31,400	19,600	3.36	2.42	8.50	CH33-44/48	SL280UH090V36B	5613538
XP17N-036-230	35,800	15.50	13.00	31,600	19,800	3.40	2.42	8.50	CH33-44/48	SL280UH090V48B	5613547
XP17N-036-230	35,800	15.50	13.00	31,600	19,800	3.40	2.42	8.50	CH33-44/48	SL280UH090XV48B	5613566
XP17N-036-230	35,200	15.00	12.70	31,600	19,900	3.30	2.38	8.20	CH33-44/48	SLP98UH070XV36B	5613609
XP17N-036-230	35,200	14.00	12.00	32,200	20,400	3.22	2.28	8.20	CH33-44/48		5613649
XP17N-036-230	35,800	15.50	13.00	31,400	19,800	3.40	2.44	8.50	CH33-48	EL180UH090E60C	5740274
XP17N-036-230	35,400	15.50	13.00	31,200	19,600	3.34	2.44	8.20	CH33-48	EL180UH110E60C	5740729
XP17N-036-230	35,400	15.50	13.00	31,200	19,600	3.34	2.44	8.20	CH33-48	EL180UH110XE60C	5740946
XP17N-036-230	35,400	15.50	13.00	31,200	19,600	3.34	2.44	8.20	CH33-48	EL296UH090XV36C	5613419
XP17N-036-230	35,600	15.70	13.00	31,200	19,700	3.38	2.46	8.50	CH33-48	EL296UH090XV48C	5613429
XP17N-036-230	36,200	15.70	13.20	31,600	19,900	3.48	2.50	8.70	CH33-48	EL296UH110XV60C	5613449
XP17N-036-230	36,400	15.70	13.20	31,600	19,900	3.48	2.50	8.70	CH33-48	SL280UH090V60C	5613555
XP17N-036-230	36,400	15.70	13.20	31,600	19,900	3.48	2.50	8.70	CH33-48	SL280UH090XV60C	5613574
XP17N-036-230	36,200	15.50	13.00	31,600	19,900	3.44	2.48	8.50	CH33-48	SL280UH110V60C	5613584
XP17N-036-230	36,200	15.50	13.00	31,600	19,900	3.44	2.48	8.50	CH33-48	SL280UH110XV60C	5613594
XP17N-036-230	35,400	15.50	13.00	31,200	19,600	3.34	2.44	8.20	CH33-48	SLP98UH090XV36C	5613617
XP17N-036-230	35,600	15.70	13.00	31,200	19,700	3.38	2.46	8.50	CH33-48	SLP98UH090XV48C	5613627
XP17N-036-230	36,200	15.70	13.20	31,600	19,900	3.48	2.50	8.70	CH33-48	SLP98UH110XV60C	5613636
XP17N-036-230	35,400	14.20	12.00	32,000	20,400	3.22	2.32	8.20	CH33-48		5613650
XP17N-036-230	35,600	15.50	13.00	31,200	19,800	3.40	2.44	8.50	CH33-48C	EL195UH090XE48C	5613388
XP17N-036-230	36,200	15.70	13.00	31,600	19,900	3.44	2.46	8.50	CH33-48C	EL195UH110XE60C	5613398
XP17N-036-230	35,600	15.50	13.00	31,200	19,800	3.40	2.44	8.50	CH33-48C	EL296UH090XE48C	5650903
XP17N-036-230	36,200	15.70	13.00	31,600	19,900	3.44	2.46	8.50	CH33-48C	EL296UH110XE60C	5650920
XP17N-036-230	36,200	15.70	13.00	31,600	19,900	3.46	2.48	8.50	CH33-48C	EL296UH110XV48C	5613439
XP17N-036-230	36,600	15.70	13.20	31,600	19,900	3.60	2.58	8.70	CH33-49	EL180UH090E60C	5740277
XP17N-036-230	36,400	16.00	13.20	31,400	19,700	3.58	2.56	8.70	CH33-49	EL180UH110E60C	5740732
XP17N-036-230	36,400	16.00	13.20	31,400	19,700	3.58	2.56	8.70	CH33-49	EL180UH110XE60C	5740938
XP17N-036-230	36,200	15.70	13.20	31,400	19,900	3.56	2.54	8.50	CH33-49	EL195UH090XE48C	5613389
XP17N-036-230	36,800	15.70	13.20	31,800	19,900	3.60	2.56	8.70	CH33-49	EL195UH110XE60C	5613399
XP17N-036-230	36,200	15.70	13.20	31,400	19,900	3.56	2.54	8.50	CH33-49	EL296UH090XE48C	5650937
XP17N-036-230	35,800	15.70	13.20	31,200	19,700	3.48	2.52	8.50	CH33-49	EL296UH090XV36C	5613420
XP17N-036-230	36,200	15.70	13.20	31,400	19,700	3.56	2.56	8.50	CH33-49	EL296UH090XV48C	5613430
XP17N-036-230	36,800	15.70	13.20	31,800	19,900	3.60	2.56	8.70	CH33-49	EL296UH110XE60C	5650930

NOTES:

Ratings are AHRI certified to AHRI Standard 210/240 (with 25 ft. of connecting refrigerant lines);

- Cooling Ratings - 95°F outdoor air temperature and 80 °F db/67° F wb entering indoor coil air.
- High Temperature Heating Ratings - 47° F db/43° F wb outdoor air temperature and 70 °F db entering indoor coil air.
- Low Temperature Heating Ratings - 17 °F db/15° F wb outdoor air temperature and 70 °F db entering indoor coil air.

All ratings include the use of a blower time delay relay (TDR). All Lennox variable-speed Furnaces and Air Handlers have time delay capabilities. Other Furnaces and Air Handlers may require an optional time delay relay (58M81) for field installation. See furnace or air handler specifications to determine if relay is needed.

Also see TXV Substitution Table at the beginning of the Heat Pump AHRI System Matches section.

When used with gas furnaces, a dual-fuel control, a control system with dual-fuel capabilities (LZP-2 or LZP-4), or a thermostat with dual-fuel capabilities must be used (order separately).

To convert HSPF from Region IV to Region V - Divide by 1.15.

AHRI SYSTEM MATCHES

Model No.	Cooling Capacity	SEER	EER	Heat Capacity		Heat COP		HSPF (IV)	Coil or Air Handler	Furnace	AHRI Reference
				High	Low	High	Low				
XP17N-036-230	36,800	15.70	13.20	31,800	20,000	3.60	2.56	8.70	CH33-49	EL296UH110XV48C	5613440
XP17N-036-230	36,800	15.70	13.20	31,800	20,000	3.62	2.58	8.70	CH33-49	EL296UH110XV60C	5613450
XP17N-036-230	37,000	16.00	13.20	31,800	20,000	3.64	2.58	8.70	CH33-49	SL280UH090V60C	5613556
XP17N-036-230	37,000	16.00	13.20	31,800	20,000	3.64	2.58	8.70	CH33-49	SL280UH090XV60C	5613575
XP17N-036-230	36,800	15.70	13.20	31,800	20,000	3.60	2.54	8.70	CH33-49	SL280UH110XV60C	5613595
XP17N-036-230	35,800	15.70	13.20	31,200	19,700	3.48	2.52	8.50	CH33-49	SLP98UH090XV36C	5613618
XP17N-036-230	36,200	15.70	13.20	31,400	19,700	3.56	2.56	8.50	CH33-49	SLP98UH090XV48C	5613628
XP17N-036-230	36,800	15.70	13.20	31,800	20,000	3.60	2.54	8.70	CH33-49	SLP98UH110V60C	5613585
XP17N-036-230	36,800	15.70	13.20	31,800	20,000	3.62	2.58	8.70	CH33-49	SLP98UH110XV60C	5613637
XP17N-036-230	35,800	14.20	12.00	32,200	20,600	3.36	2.42	8.20	CH33-49		5613651
XP17N-036-230	36,200	15.70	13.00	31,600	19,900	3.52	2.54	8.50	CH33-50/60C	EL180UH090E60C	5740272
XP17N-036-230	35,800	15.50	13.00	31,400	19,700	3.48	2.50	8.50	CH33-50/60C	EL180UH110E60C	5740735
XP17N-036-230	35,800	15.50	13.00	31,400	19,700	3.48	2.50	8.50	CH33-50/60C	EL180UH110XE60C	5740947
XP17N-036-230	35,800	15.50	12.70	31,400	19,800	3.46	2.50	8.50	CH33-50/60C	EL195UH090XE48C	5613390
XP17N-036-230	36,200	15.50	13.00	31,600	19,900	3.52	2.52	8.50	CH33-50/60C	EL195UH110XE60C	5613400
XP17N-036-230	35,800	15.50	12.70	31,400	19,800	3.46	2.50	8.50	CH33-50/60C	EL296UH090XE48C	5650919
XP17N-036-230	35,600	15.70	13.00	31,200	19,600	3.46	2.50	8.50	CH33-50/60C	EL296UH090XV36C	5613421
XP17N-036-230	36,000	15.70	13.20	31,400	19,700	3.52	2.52	8.50	CH33-50/60C	EL296UH090XV48C	5613431
XP17N-036-230	36,200	15.50	13.00	31,600	19,900	3.52	2.52	8.50	CH33-50/60C	EL296UH110XE60C	5650909
XP17N-036-230	36,600	15.70	13.20	31,800	20,000	3.60	2.56	8.70	CH33-50/60C	EL296UH110XV48C	5613441
XP17N-036-230	36,600	15.70	13.20	31,800	20,000	3.60	2.56	8.70	CH33-50/60C	EL296UH110XV60C	5613451
XP17N-036-230	36,800	15.70	13.20	31,800	20,000	3.62	2.58	8.70	CH33-50/60C	SL280UH090V60C	5613557
XP17N-036-230	36,800	15.70	13.20	31,800	20,000	3.62	2.58	8.70	CH33-50/60C	SL280UH090XV60C	5613576
XP17N-036-230	36,600	15.50	13.00	31,800	20,000	3.58	2.54	8.70	CH33-50/60C	SL280UH110V60C	5613586
XP17N-036-230	36,600	15.50	13.00	31,800	20,000	3.58	2.54	8.70	CH33-50/60C	SL280UH110XV60C	5613596
XP17N-036-230	35,600	15.70	13.00	31,200	19,600	3.46	2.50	8.50	CH33-50/60C	SLP98UH090XV36C	5613619
XP17N-036-230	36,000	15.70	13.20	31,400	19,700	3.52	2.52	8.50	CH33-50/60C	SLP98UH090XV48C	5613629
XP17N-036-230	36,600	15.70	13.20	31,800	20,000	3.60	2.56	8.70	CH33-50/60C	SLP98UH110XV60C	5613638
XP17N-036-230	35,600	14.20	12.00	32,200	20,400	3.34	2.40	8.20	CH33-50/60C		5613652
XP17N-036-230	35,400	15.70	13.00	31,600	20,000	3.18	2.30	8.20	CR33-48	EL180DF070E36B	5741563
XP17N-036-230	35,600	15.00	12.50	31,800	20,200	3.24	2.32	8.50	CR33-48	EL180DF090E48B	5741588
XP17N-036-230	36,000	15.00	12.50	31,800	20,200	3.26	2.34	8.50	CR33-48	EL180DF110E60C	5741640
XP17N-036-230	35,800	14.70	12.20	32,400	20,800	3.16	2.26	8.20	CR33-48	EL195DF045XE36B	5613366
XP17N-036-230	35,600	15.50	12.70	31,800	20,200	3.20	2.28	8.20	CR33-48	EL195DF070XE48B	5613367
XP17N-036-230	35,600	15.50	12.70	31,600	20,200	3.24	2.30	8.50	CR33-48	EL195DF090XE48C	5613368
XP17N-036-230	35,800	15.70	13.00	31,800	20,200	3.24	2.32	8.50	CR33-48	EL195DF110XE60C	5613369
XP17N-036-230	35,800	14.70	12.20	32,400	20,800	3.16	2.26	8.20	CR33-48	EL296DF045XE36B	5650914
XP17N-036-230	35,800	15.20	12.70	32,000	20,400	3.22	2.30	8.20	CR33-48	EL296DF045XV36B	5613404
XP17N-036-230	35,600	15.50	12.70	31,800	20,200	3.20	2.28	8.20	CR33-48	EL296DF070XE48B	5650926
XP17N-036-230	35,800	15.20	12.50	32,200	20,600	3.22	2.28	8.20	CR33-48	EL296DF070XV48B	5613405
XP17N-036-230	35,600	15.50	12.70	31,600	20,200	3.24	2.30	8.50	CR33-48	EL296DF090XE48C	5650904
XP17N-036-230	35,800	15.70	13.00	31,800	20,200	3.24	2.32	8.50	CR33-48	EL296DF110XE60C	5650911
XP17N-036-230	35,600	15.00	12.50	31,800	20,200	3.22	2.32	8.50	CR33-48	SL280DF090V48B	5613526
XP17N-036-230	36,600	15.00	12.50	32,200	20,400	3.34	2.36	8.50	CR33-48	SL280DF090V60C	5613527
XP17N-036-230	36,200	15.00	12.50	31,800	20,200	3.30	2.36	8.50	CR33-48	SL280DF110V60C	5613528
XP17N-036-230	35,600	15.50	12.70	31,800	20,200	3.20	2.30	8.20	CR33-48	SLP98DF070XV36B	5613600
XP17N-036-230	35,600	15.70	13.00	31,800	20,200	3.22	2.32	8.50	CR33-48	SLP98DF090XV36C	5613601

NOTES:

Ratings are AHRI certified to AHRI Standard 210/240 (with 25 ft. of connecting refrigerant lines);

• Cooling Ratings - 95°F outdoor air temperature and 80 °F db/67° F wb entering indoor coil air.

• High Temperature Heating Ratings - 47° F db/43° F wb outdoor air temperature and 70 °F db entering indoor coil air.

• Low Temperature Heating Ratings - 17 °F db/15° F wb outdoor air temperature and 70 °F db entering indoor coil air.

All ratings include the use of a blower time delay relay (TDR). All Lennox variable-speed Furnaces and Air Handlers have time delay capabilities. Other Furnaces and Air Handlers may require an optional time delay relay (58M81) for field installation. See furnace or air handler specifications to determine if relay is needed.

Also see TXV Substitution Table at the beginning of the Heat Pump AHRI System Matches section.

When used with gas furnaces, a dual-fuel control, a control system with dual-fuel capabilities (LZP-2 or LZP-4), or a thermostat with dual-fuel capabilities must be used (order separately).

To convert HSPF from Region IV to Region V - Divide by 1.15.

AHRI SYSTEM MATCHES

Model No.	Cooling Capacity	SEER	EER	Heat Capacity		Heat COP		HSPF (IV)	Coil or Air Handler	Furnace	AHRI Reference
				High	Low	High	Low				
XP17N-036-230	35,600	15.70	13.00	31,600	20,000	3.20	2.32	8.50	CR33-48	SLP98DF090XV48C	5613602
XP17N-036-230	36,400	15.70	13.20	32,200	20,400	3.28	2.34	8.50	CR33-48	SLP98DF110XV60C	5613603
XP17N-036-230	35,400	14.50	12.00	32,400	20,800	3.08	2.22	8.00	CR33-48		5613653
XP17N-036-230	36,600	15.50	13.20	32,000	20,400	3.66	2.58	9.20	CR33-50/60	EL180DF110E60C	5741639
XP17N-036-230	36,400	15.20	13.00	32,200	20,600	3.62	2.56	9.00	CR33-50/60	EL195DF090XE48C	5550116
XP17N-036-230	36,600	15.50	13.00	32,200	20,600	3.64	2.54	9.00	CR33-50/60	EL195DF110XE60C	5550117
XP17N-036-230	36,400	15.20	13.00	32,200	20,600	3.62	2.56	9.00	CR33-50/60	EL296DF090XE48C	5650859
XP17N-036-230	36,600	15.50	13.00	32,200	20,600	3.64	2.54	9.00	CR33-50/60	EL296DF110XE60C	5650860
XP17N-036-230	36,400	15.50	13.20	32,000	20,400	3.64	2.58	9.20	CR33-50/60	SL280DF110V60C	5550119
XP17N-036-230	35,800	15.20	12.70	32,000	20,400	3.54	2.52	9.00	CR33-50/60	SLP98DF090XV36C	5550120
XP17N-036-230	35,800	15.50	13.00	31,800	20,400	3.54	2.52	9.00	CR33-50/60	SLP98DF090XV48C	5550121
XP17N-036-230	36,600	15.20	13.00	32,200	20,600	3.62	2.56	9.00	CR33-50/60	SLP98DF090XV60C	5550122
XP17N-036-230	36,600	15.20	13.00	32,200	20,600	3.62	2.56	9.00	CR33-50/60	SLP98DF110XV60C	5550123
XP17N-036-230	35,800	14.00	12.00	32,600	21,000	3.38	2.40	8.50	CR33-50/60		5550115
XP17N-036-230	35,400	14.70	12.50	31,800	20,000	3.14	2.28	8.00	CX34-38	EL180UH045E36A	5741779
XP17N-036-230	35,400	14.70	12.50	31,800	20,000	3.14	2.28	8.00	CX34-38	EL180UH045XE36A	5741849
XP17N-036-230	35,200	15.50	13.00	31,200	19,600	3.16	2.32	8.20	CX34-38	EL180UH070E36B	5742084
XP17N-036-230	35,200	15.50	13.00	31,200	19,600	3.16	2.32	8.20	CX34-38	EL180UH070XE36B	5742201
XP17N-036-230	36,000	15.20	12.70	31,800	20,000	3.24	2.34	8.20	CX34-38	EL180UH090E48B	5742403
XP17N-036-230	36,000	15.20	12.70	31,800	20,000	3.24	2.34	8.20	CX34-38	EL180UH090XE48B	5740402
XP17N-036-230	35,400	14.20	12.20	32,000	20,400	3.12	2.26	8.00	CX34-38	EL195UH045XE36B	5613375
XP17N-036-230	35,400	14.50	12.20	31,400	20,200	3.14	2.28	8.00	CX34-38	EL195UH070XE36B	5613382
XP17N-036-230	35,400	14.20	12.20	32,000	20,400	3.12	2.26	8.00	CX34-38	EL296UH045XE36B	5650927
XP17N-036-230	35,400	14.50	12.20	31,400	20,200	3.14	2.28	8.00	CX34-38	EL296UH070XE36B	5650916
XP17N-036-230	35,400	15.00	12.70	31,400	19,800	3.14	2.28	8.20	CX34-38	EL296UH070XV36B	5613412
XP17N-036-230	35,600	15.00	12.50	31,800	20,000	3.20	2.32	8.20	CX34-38	SL280UH070V36A	5613530
XP17N-036-230	35,600	15.00	12.50	31,800	20,000	3.20	2.32	8.20	CX34-38	SL280UH070XV36A	5613532
XP17N-036-230	35,400	15.50	13.00	31,200	19,600	3.18	2.34	8.20	CX34-38	SL280UH090V36B	5613539
XP17N-036-230	35,800	15.50	13.00	31,600	19,800	3.22	2.34	8.20	CX34-38	SL280UH090V48B	5613548
XP17N-036-230	35,800	15.50	13.00	31,600	19,800	3.22	2.34	8.20	CX34-38	SL280UH090XV48B	5613567
XP17N-036-230	35,400	15.00	12.70	31,400	19,800	3.14	2.28	8.20	CX34-38	SLP98UH070XV36B	5613610
XP17N-036-230	35,200	14.00	12.00	32,200	20,400	3.08	2.24	8.00	CX34-38		5613654
XP17N-036-230	35,600	15.70	13.00	31,200	19,600	3.30	2.38	8.20	CX34-43	EL180UH070E36B	5742080
XP17N-036-230	36,000	15.70	13.20	31,400	19,900	3.30	2.38	8.50	CX34-43	EL180UH070XE36B	5742205
XP17N-036-230	36,200	15.50	13.00	31,800	20,000	3.36	2.40	8.50	CX34-43	EL180UH090E48B	5742398
XP17N-036-230	36,200	15.70	13.20	31,600	19,800	3.38	2.42	8.50	CX34-43	EL180UH090E60C	5740273
XP17N-036-230	36,800	15.50	13.00	31,800	20,200	3.36	2.40	8.50	CX34-43	EL180UH090XE48B	5740404
XP17N-036-230	36,000	15.70	13.20	31,400	19,700	3.36	2.40	8.50	CX34-43	EL180UH110E60C	5740727
XP17N-036-230	36,000	15.70	13.20	31,400	19,700	3.36	2.40	8.50	CX34-43	EL180UH110XE60C	5740942
XP17N-036-230	35,800	14.50	12.20	32,000	20,400	3.22	2.32	8.20	CX34-43	EL195UH045XE36B	5613376
XP17N-036-230	35,600	14.70	12.20	31,400	20,200	3.24	2.32	8.20	CX34-43	EL195UH070XE36B	5613383
XP17N-036-230	35,800	15.50	13.00	31,400	19,800	3.34	2.38	8.50	CX34-43	EL195UH090XE48C	5613391
XP17N-036-230	36,400	15.70	13.20	31,600	19,900	3.40	2.42	8.50	CX34-43	EL195UH110XE60C	5613401
XP17N-036-230	35,800	14.50	12.20	32,000	20,400	3.22	2.32	8.20	CX34-43	EL296UH045XE36B	5650905
XP17N-036-230	35,600	14.70	12.20	31,400	20,200	3.24	2.32	8.20	CX34-43	EL296UH070XE36B	5650928
XP17N-036-230	35,600	15.20	12.70	31,400	19,800	3.26	2.36	8.20	CX34-43	EL296UH070XV36B	5613413
XP17N-036-230	35,800	15.50	13.00	31,400	19,800	3.34	2.38	8.50	CX34-43	EL296UH090XE48C	5650929

NOTES:

Ratings are AHRI certified to AHRI Standard 210/240 (with 25 ft. of connecting refrigerant lines);

- Cooling Ratings - 95°F outdoor air temperature and 80 °F db/67° F wb entering indoor coil air.
- High Temperature Heating Ratings - 47° F db/43° F wb outdoor air temperature and 70 °F db entering indoor coil air.
- Low Temperature Heating Ratings - 17 °F db/15° F wb outdoor air temperature and 70 °F db entering indoor coil air.

All ratings include the use of a blower time delay relay (TDR). All Lennox variable-speed Furnaces and Air Handlers have time delay capabilities. Other Furnaces and Air Handlers may require an optional time delay relay (58M81) for field installation. See furnace or air handler specifications to determine if relay is needed.

Also see TXV Substitution Table at the beginning of the Heat Pump AHRI System Matches section.

When used with gas furnaces, a dual-fuel control, a control system with dual-fuel capabilities (LZP-2 or LZP-4), or a thermostat with dual-fuel capabilities must be used (order separately).

To convert HSPF from Region IV to Region V - Divide by 1.15.

AHRI SYSTEM MATCHES

Model No.	Cooling Capacity	SEER	EER	Heat Capacity		Heat COP		HSPF (IV)	Coil or Air Handler	Furnace	AHRI Reference
				High	Low	High	Low				
XP17N-036-230	35,600	15.50	13.00	31,200	19,600	3.28	2.38	8.20	CX34-43	EL296UH090XV36C	5613422
XP17N-036-230	35,800	15.70	13.00	31,400	19,700	3.32	2.40	8.50	CX34-43	EL296UH090XV48C	5613432
XP17N-036-230	36,400	15.70	13.20	31,600	19,900	3.40	2.42	8.50	CX34-43	EL296UH110XE60C	5650918
XP17N-036-230	36,400	15.70	13.20	31,600	19,900	3.40	2.42	8.50	CX34-43	EL296UH110XV48C	5613442
XP17N-036-230	36,400	15.70	13.20	31,600	19,900	3.42	2.44	8.70	CX34-43	EL296UH110XV60C	5613452
XP17N-036-230	35,800	15.70	13.20	31,200	19,600	3.32	2.40	8.50	CX34-43	SL280UH090V36B	5613540
XP17N-036-230	36,000	15.70	13.20	31,400	19,800	3.36	2.40	8.50	CX34-43	SL280UH090V48B	5613549
XP17N-036-230	36,600	15.70	13.20	31,800	19,900	3.44	2.44	8.70	CX34-43	SL280UH090V60C	5613558
XP17N-036-230	36,000	15.70	13.20	31,400	19,800	3.36	2.40	8.50	CX34-43	SL280UH090XV48B	5613568
XP17N-036-230	36,600	15.70	13.20	31,800	19,900	3.44	2.44	8.70	CX34-43	SL280UH090XV60C	5613577
XP17N-036-230	36,400	15.50	13.20	31,600	20,000	3.38	2.42	8.50	CX34-43	SL280UH110V60C	5613587
XP17N-036-230	36,400	15.50	13.20	31,600	20,000	3.38	2.42	8.50	CX34-43	SL280UH110XV60C	5613597
XP17N-036-230	35,600	15.20	12.70	31,400	19,800	3.26	2.36	8.20	CX34-43	SLP98UH070XV36B	5613611
XP17N-036-230	35,600	15.50	13.00	31,200	19,600	3.28	2.38	8.20	CX34-43	SLP98UH090XV36C	5613620
XP17N-036-230	35,800	15.70	13.00	31,400	19,700	3.32	2.40	8.50	CX34-43	SLP98UH090XV48C	5613630
XP17N-036-230	36,400	15.70	13.20	31,600	19,900	3.42	2.44	8.70	CX34-43	SLP98UH110XV60C	5613639
XP17N-036-230	35,400	14.20	12.00	32,000	20,400	3.18	2.26	8.00	CX34-43		5613655
XP17N-036-230	34,000	14.70	12.20	30,800	19,500	2.88	2.34	8.20	CX34-44/48	EL180UH070E36B	5742082
XP17N-036-230	34,000	14.70	12.20	31,600	21,000	2.88	2.34	8.20	CX34-44/48	EL180UH070XE36B	5742204
XP17N-036-230	34,600	14.50	12.20	31,600	19,900	2.96	2.38	8.20	CX34-44/48	EL180UH090E48B	5742400
XP17N-036-230	34,400	14.70	12.20	31,200	19,700	2.94	2.36	8.20	CX34-44/48	EL180UH090E60C	5740276
XP17N-036-230	34,600	14.50	12.20	32,000	21,400	2.96	2.38	8.20	CX34-44/48	EL180UH090XE48B	5740398
XP17N-036-230	34,200	14.70	12.20	31,000	19,500	2.88	2.34	8.20	CX34-44/48	EL180UH110E60C	5740737
XP17N-036-230	34,200	14.70	12.20	31,000	19,500	2.88	2.34	8.20	CX34-44/48	EL180UH110XE60C	5740945
XP17N-036-230	34,200	14.50	12.20	31,000	19,700	2.90	2.34	8.20	CX34-44/48	EL195UH090XE48C	5613392
XP17N-036-230	34,600	14.70	12.20	31,400	19,800	2.94	2.36	8.20	CX34-44/48	EL195UH110XE60C	5613402
XP17N-036-230	34,000	14.50	12.20	31,000	19,700	2.88	2.32	8.00	CX34-44/48	EL296UH070XV36B	5613414
XP17N-036-230	34,200	14.50	12.20	31,000	19,700	2.90	2.34	8.20	CX34-44/48	EL296UH090XE48C	5650907
XP17N-036-230	34,000	14.70	12.20	30,800	19,500	2.88	2.32	8.20	CX34-44/48	EL296UH090XV36C	5613423
XP17N-036-230	34,400	14.70	12.50	31,000	19,600	2.92	2.38	8.20	CX34-44/48	EL296UH090XV48C	5613433
XP17N-036-230	34,600	14.70	12.20	31,400	19,800	2.94	2.36	8.20	CX34-44/48	EL296UH110XE60C	5650925
XP17N-036-230	34,800	14.70	12.50	31,400	19,800	3.00	2.38	8.20	CX34-44/48	EL296UH110XV48C	5613443
XP17N-036-230	34,800	14.70	12.50	31,400	19,800	3.02	2.38	8.50	CX34-44/48	EL296UH110XV60C	5613453
XP17N-036-230	34,200	14.70	12.50	31,000	19,500	2.92	2.36	8.20	CX34-44/48	SL280UH090V36B	5613541
XP17N-036-230	34,600	14.70	12.50	31,200	19,700	2.96	2.38	8.20	CX34-44/48	SL280UH090V48B	5613550
XP17N-036-230	35,000	15.00	12.50	31,400	19,800	3.04	2.42	8.50	CX34-44/48	SL280UH090V60C	5613559
XP17N-036-230	34,600	14.70	12.50	31,200	19,700	2.96	2.38	8.20	CX34-44/48	SL280UH090XV48B	5613569
XP17N-036-230	35,000	15.00	12.50	31,400	19,800	3.04	2.42	8.50	CX34-44/48	SL280UH090XV60C	5613578
XP17N-036-230	34,600	14.70	12.20	31,400	19,900	2.98	2.40	8.20	CX34-44/48	SL280UH110V60C	5613588
XP17N-036-230	34,600	14.70	12.20	31,400	19,900	2.98	2.40	8.20	CX34-44/48	SL280UH110XV60C	5613598
XP17N-036-230	34,000	14.50	12.20	31,000	19,700	2.88	2.32	8.00	CX34-44/48	SLP98UH070XV36B	5613612
XP17N-036-230	34,000	14.70	12.20	30,800	19,500	2.88	2.32	8.20	CX34-44/48	SLP98UH090XV36C	5613621
XP17N-036-230	34,400	14.70	12.50	31,000	19,600	2.92	2.38	8.20	CX34-44/48	SLP98UH090XV48C	5549413
XP17N-036-230	34,800	14.70	12.50	31,400	19,800	3.02	2.38	8.50	CX34-44/48	SLP98UH110XV60C	5613640
XP17N-036-230	34,000	13.00	11.00	31,800	20,400	2.82	2.26	8.00	CX34-44/48		5613656
XP17N-036-230	36,200	15.20	13.00	31,600	19,900	3.44	2.40	8.50	CX34-49	EL180UH090E60C	5740270
XP17N-036-230	35,800	15.50	13.00	31,200	19,700	3.36	2.36	8.50	CX34-49	EL180UH110E60C	5740725

NOTES:

Ratings are AHRI certified to AHRI Standard 210/240 (with 25 ft. of connecting refrigerant lines);

• Cooling Ratings - 95°F outdoor air temperature and 80 °F db/67° F wb entering indoor coil air.

• High Temperature Heating Ratings - 47° F db/43° F wb outdoor air temperature and 70 °F db entering indoor coil air.

• Low Temperature Heating Ratings - 17 °F db/15° F wb outdoor air temperature and 70 °F db entering indoor coil air.

All ratings include the use of a blower time delay relay (TDR). All Lennox variable-speed Furnaces and Air Handlers have time delay capabilities. Other Furnaces and Air Handlers may require an optional time delay relay (58M81) for field installation. See furnace or air handler specifications to determine if relay is needed.

Also see TXV Substitution Table at the beginning of the Heat Pump AHRI System Matches section.

When used with gas furnaces, a dual-fuel control, a control system with dual-fuel capabilities (LZP-2 or LZP-4), or a thermostat with dual-fuel capabilities must be used (order separately).

To convert HSPF from Region IV to Region V - Divide by 1.15.

AHRI SYSTEM MATCHES

Model No.	Cooling Capacity	SEER	EER	Heat Capacity		Heat COP		HSPF (IV)	Coil or Air Handler	Furnace	AHRI Reference
				High	Low	High	Low				
XP17N-036-230	35,800	15.50	13.00	31,200	19,700	3.36	2.36	8.50	CX34-49	EL180UH110XE60C	5740937
XP17N-036-230	36,000	15.20	13.00	31,400	19,900	3.44	2.40	8.50	CX34-49	EL195UH090XE48C	5549385
XP17N-036-230	36,600	15.50	13.00	31,600	19,900	3.48	2.42	8.70	CX34-49	EL195UH110XE60C	5549387
XP17N-036-230	36,000	15.20	13.00	31,400	19,900	3.44	2.40	8.50	CX34-49	EL296UH090XE48C	5650839
XP17N-036-230	35,800	15.20	13.00	31,200	19,700	3.36	2.36	8.50	CX34-49	EL296UH090XV36C	5549389
XP17N-036-230	36,000	15.50	13.00	31,400	19,800	3.42	2.38	8.50	CX34-49	EL296UH090XV48C	5549391
XP17N-036-230	36,600	15.50	13.00	31,600	19,900	3.48	2.42	8.70	CX34-49	EL296UH110XE60C	5650837
XP17N-036-230	37,400	15.50	13.00	31,600	20,200	3.48	2.42	8.70	CX34-49	EL296UH110XV48C	5549393
XP17N-036-230	36,600	15.50	13.00	31,600	20,000	3.50	2.42	8.70	CX34-49	EL296UH110XV60C	5549395
XP17N-036-230	36,800	15.50	13.20	31,600	20,000	3.50	2.44	8.70	CX34-49	SL280UH090V60C	5549403
XP17N-036-230	36,800	15.50	13.20	31,600	20,000	3.50	2.44	8.70	CX34-49	SL280UH090XV60C	5549405
XP17N-036-230	36,600	15.50	13.00	31,600	20,000	3.46	2.40	8.50	CX34-49	SL280UH110V60C	5549407
XP17N-036-230	36,600	15.50	13.00	31,600	20,000	3.46	2.40	8.50	CX34-49	SL280UH110XV60C	5549409
XP17N-036-230	35,800	15.20	13.00	31,200	19,700	3.36	2.36	8.50	CX34-49	SLP98UH090XV36C	5549411
XP17N-036-230	36,600	15.50	13.00	31,600	20,000	3.50	2.42	8.70	CX34-49	SLP98UH110XV60C	5549415
XP17N-036-230	35,800	14.00	12.00	32,200	20,600	3.28	2.28	8.20	CX34-49		5549427
XP17N-036-230	35,800	15.50	13.00	31,400	19,800	3.34	2.38	8.50	CX34-50/60C	EL180UH090E60C	5740279
XP17N-036-230	35,400	15.50	13.00	31,200	19,600	3.28	2.36	8.20	CX34-50/60C	EL180UH110E60C	5740731
XP17N-036-230	35,400	15.50	13.00	31,200	19,600	3.28	2.36	8.20	CX34-50/60C	EL180UH110XE60C	5740940
XP17N-036-230	35,600	15.50	13.00	31,200	19,800	3.34	2.38	8.50	CX34-50/60C	EL195UH090XE48C	5613393
XP17N-036-230	36,200	15.50	13.00	31,600	19,900	3.36	2.42	8.50	CX34-50/60C	EL195UH110XE60C	5613403
XP17N-036-230	35,600	15.50	13.00	31,200	19,800	3.34	2.38	8.50	CX34-50/60C	EL296UH090XE48C	5650917
XP17N-036-230	35,400	15.50	13.00	31,200	19,600	3.26	2.36	8.20	CX34-50/60C	EL296UH090XV36C	5613424
XP17N-036-230	35,600	15.50	13.00	31,200	19,700	3.32	2.40	8.50	CX34-50/60C	EL296UH090XV48C	5613434
XP17N-036-230	36,200	15.50	13.00	31,600	19,900	3.36	2.42	8.50	CX34-50/60C	EL296UH110XE60C	5650910
XP17N-036-230	36,200	15.50	13.00	31,600	19,900	3.38	2.42	8.50	CX34-50/60C	EL296UH110XV48C	5613444
XP17N-036-230	36,200	15.70	13.20	31,600	19,900	3.40	2.44	8.50	CX34-50/60C	EL296UH110XV60C	5613454
XP17N-036-230	36,400	15.70	13.20	31,600	19,900	3.42	2.44	8.70	CX34-50/60C	SL280UH090V60C	5613560
XP17N-036-230	36,400	15.70	13.20	31,600	19,900	3.42	2.44	8.70	CX34-50/60C	SL280UH090XV60C	5613579
XP17N-036-230	36,200	15.50	13.00	31,600	19,900	3.36	2.40	8.50	CX34-50/60C	SL280UH110V60C	5613589
XP17N-036-230	34,800	15.20	12.50	31,400	19,800	3.36	2.40	8.20	CX34-50/60C	SL280UH110XV60C	5613599
XP17N-036-230	35,400	15.50	13.00	31,200	19,600	3.26	2.36	8.20	CX34-50/60C	SLP98UH090XV36C	5613622
XP17N-036-230	35,600	15.50	13.00	31,200	19,700	3.32	2.40	8.50	CX34-50/60C	SLP98UH090XV48C	5613631
XP17N-036-230	36,200	15.70	13.20	31,600	19,900	3.40	2.44	8.50	CX34-50/60C	SLP98UH110XV60C	5613641
XP17N-036-230	35,400	14.20	12.00	32,000	20,400	3.16	2.26	8.00	CX34-50/60C		5613657

NOTES:

Ratings are AHRI certified to AHRI Standard 210/240 (with 25 ft. of connecting refrigerant lines);

- Cooling Ratings - 95°F outdoor air temperature and 80 °F db/67° F wb entering indoor coil air.
- High Temperature Heating Ratings - 47° F db/43° F wb outdoor air temperature and 70 °F db entering indoor coil air.
- Low Temperature Heating Ratings - 17 °F db/15° F wb outdoor air temperature and 70 °F db entering indoor coil air.

All ratings include the use of a blower time delay relay (TDR). All Lennox variable-speed Furnaces and Air Handlers have time delay capabilities. Other Furnaces and Air Handlers may require an optional time delay relay (58M81) for field installation. See furnace or air handler specifications to determine if relay is needed.

Also see TXV Substitution Table at the beginning of the Heat Pump AHRI System Matches section.

When used with gas furnaces, a dual-fuel control, a control system with dual-fuel capabilities (LZP-2 or LZP-4), or a thermostat with dual-fuel capabilities must be used (order separately).

To convert HSPF from Region IV to Region V - Divide by 1.15.

REVISIONS

Sections	Description of Change
Optional Accessories	New Mild Weather Kit.



Visit us at www.lennox.com

For the latest technical information, www.lennox.com/lennox-davenet

Contact us at 1-800-4-LENNOX

NOTE - Due to Lennox' ongoing commitment to quality, Specifications, Ratings and Dimensions subject to change without notice and without incurring liability. Improper installation, adjustment, alteration, service or maintenance can cause property damage or personal injury. Installation and service must be performed by a qualified installer and servicing agency.

©2014 Lennox Industries, Inc.